

PERMIT

CITY OF NAPOLEON - BUILDING DEPARTMENT
255 West Riverview Avenue, Napoleon, Ohio 43545 - 419-592-4010

Permit No. 174-78 Issued 10-5-78
date

Job Location 114 Brownell St.
address

Lot 2 Springwells Add'n.
sub-div or legal discript

Issued By R.D. Sommerberg
building official

Owner Gregory Rudolph
name tel.

Address 114 Brownell St.

Agent Max. D. Reimund 256-7240
builder-eng.-etc. tel.

Address Malinta Ohio

Description of Use Addition to Single
family dwelling

Residential one
no. dwelling units

Commercial _____ Industrial _____

New _____ Add'n. XX Alter _____ Remodel _____

Mixed Occupancy _____

Change of Occupancy _____

Estimated Cost \$ 5,000.00

FEES	BASE	PLUS	TOTAL
<input checked="" type="checkbox"/> BUILDING	\$16.50		\$16.50
<input checked="" type="checkbox"/> ELECTRICAL	5.00	\$3.00	8.00
<input type="checkbox"/> PLUMBING			
<input type="checkbox"/> MECHANICAL			
<input type="checkbox"/> DEMOLITION			
<input checked="" type="checkbox"/> ZONING			0
<input type="checkbox"/> SIGN			
WATER TAP			
SEWER TAP			
TEMP. ELECT.			
ADDITIONAL PLAN REVIEW	Struct. _____ hrs	Elect. _____ hrs	
TOTAL FEES.....			\$24.50
LESS MIN. FEES PAID _____			0
		<small>date</small>	
BALANCE DUE.....			\$24.50

ZONING INFORMATION

district "LB"	lot dimensions 82.5' x 165'	area 13,612.5sq'	front yd n/a	side yds 30' W 39' E OK	rear yd 80'+ OK
max hgt OK	no pkg spaces no additional	no ldg spaces n/a	max cover OK	petition or appeal req'd -----	date appr ----

WORK INFORMATION:

Size: Length 24' Width 13.5' Stories 1 Ground Floor Area 324sq'

Height _____ Building Volume (for demo. permit) _____ cu. ft.

Electrical: 3 new circuits.
brief description

Plumbing: _____
brief description

Mechanical: _____
brief description

Sign: _____ Dimensions _____ Sign Area _____
type

Additional Information: CALL FOR INSPECTIONS MARKED ON ATTACHED SHEET:

Date Oct 6 Applicant Signature Gregory S. Rudolph
owner-agent

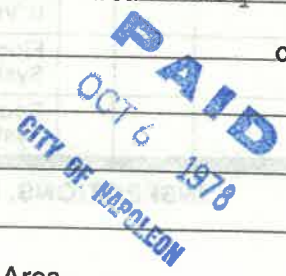

RESIDENTIAL PLAN CORRECTION SHEET

CITY OF NAPOLEON, Building Dept.
255 West Riverview Avenue
Napoleon, Ohio 43545
(419) 592-4010

ADDENDUM to Permit No. 174-78
Owner RUDOLPH
Location 14 BROWNELL

Please note the Items checked below and incorporate them into your plans as indicated: Permit not yet issued
 Correct Plans and Re-Submit. Permit issued Incorporate the Items during construction.

GENERAL	
<input type="checkbox"/>	Provide 1 approved smoke detector.
<input type="checkbox"/>	Provide 1 hour fire wall and/or ceiling between garage and dwelling.
<input type="checkbox"/>	Provide (Class B) 1 hour fire rated door from garage to dwelling.
<input type="checkbox"/>	Submit fully dimensioned plot plan.
<input type="checkbox"/>	Provide 1-3'0" x 6'8" exit door.
<input type="checkbox"/>	Provide min. 22" x 30" attic access.
<input type="checkbox"/>	Provide min. 18" x 24" crawl space access opening.
LIGHT AND VENTILATION:	
<input type="checkbox"/>	Provide mechanical exhaust or window in bathroom.....
<input type="checkbox"/>	Provide Min. _____ sq. in. net free area attic ventilation.
<input type="checkbox"/>	Provide min. _____ sq. in. net free area crawl space ventilation.
FOUNDATION:	
<input type="checkbox"/>	Min. depth of foundation below finished grade 30".
<input type="checkbox"/>	Min. size of footer....." x"
<input checked="" type="checkbox"/>	Provide anchor bolts 1/2" @ 8' o.c. 1' from each corner. Embedded 8" concrete and 15" in masonry.
<input type="checkbox"/>	Show size of basement columns.
FRAMING:	
<input type="checkbox"/>	Show size of wood girder in.....
<input type="checkbox"/>	Provide design data for structural member in.....
<input type="checkbox"/>	Floor joists under sized in.....
<input type="checkbox"/>	Provide double joists under parallel partitions.
<input checked="" type="checkbox"/>	Provide 1" x 4" let in corner bracing or approved sheathing.
<input type="checkbox"/>	Show size of headers for openings over 4' wide.
ROOFING:	
<input type="checkbox"/>	Show size of members supporting porch roof.
<input type="checkbox"/>	Provide double top plate.
<input type="checkbox"/>	Provide design data for pre-fab. wood truss/members.
<input type="checkbox"/>	Ceiling joists undersized in.....
<input type="checkbox"/>	Roof rafters undersized in.....
PLUMBING AND MECHANICAL:	
<input type="checkbox"/>	Terminate all exhaust systems to outside air.
<input type="checkbox"/>	Insulate ducts in unheated areas.
<input type="checkbox"/>	Provide back flow device on all hose bibs.
ELECTRICAL:	
<input type="checkbox"/>	Show location of service entrance and service equipment panel.
<input type="checkbox"/>	G.F.C.I. req'd. on Temp. Electric.
<input checked="" type="checkbox"/>	Outdoor and bathroom receptacles shall be protected by G.F.C.I.
METAL VENEERS:	
<input type="checkbox"/>	Contact City Utilities Dept. to remove conductors and/or meter.
<input type="checkbox"/>	Provide 18" x 18" x 3/4" wood backer for meter base.
<input type="checkbox"/>	Provide approved system of grounding and bonding.
MISCELLANEOUS:	
<input type="checkbox"/>	Provide backwater valve in sub-soil drain tile.
<input type="checkbox"/>	Provide approved sheathing and flashing behind masonry veneer.
<input type="checkbox"/>	Provide 15# felt underlayment on roof.
<input checked="" type="checkbox"/>	Provide adequate fireplace hearth extensions
<input checked="" type="checkbox"/>	Install factory built fireplaces/stoves according to manufacturers recommendations.
<input checked="" type="checkbox"/>	Terminate chimney 3' above roof or 2' above highest point of building within 10' of chimney.

ADDITIONAL CORRECTIONS: USE 2"x6" RAFTERS OF HIGH FIBER STRESS & ELASTICITY OR 2"x8" 16" o.c.

The approval of plans and specifications does not permit the violation of any section of the Building Code, or other City Ordinance or State Law. This addendum is attached to Permit No. 174-78 and made a part thereof.

Date Approved or Disapproved 10-5-78

Checked By [Signature]
 Plan Examiner

Date Rechecked and Approved _____

Checked By _____

PRESENT HOUSE

13'6"

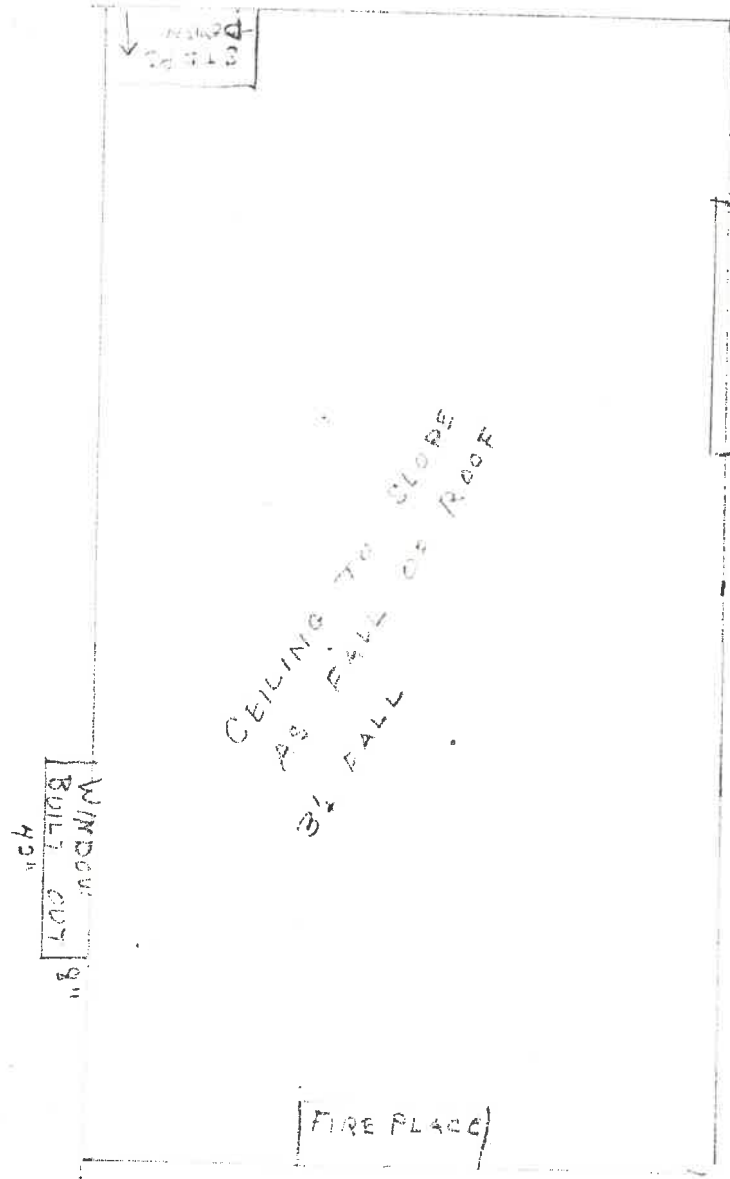

DOUBLE DOOR

24'

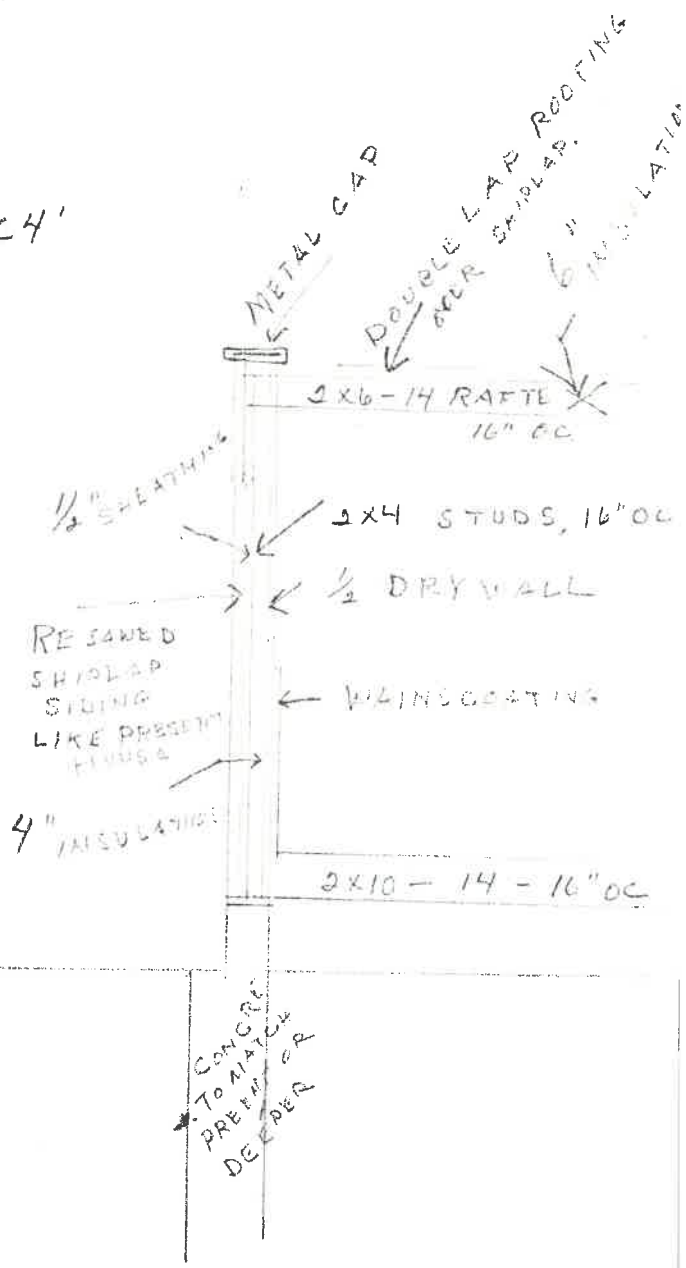

GREG RUDOLPH
 114 BROWNELL ST
 NAPOLÉON

G. RUDOLPH.
117 BROWNELL ST.
NAPOLÉON.

SIDEWALK

PORCH

PRESENT
HOUSE

10'

30'

PROPOSED
ADDITION



ALLEY

LOT LINE



BARN
GARAGE

