

PERMIT

CITY OF NAPOLEON - BUILDING DEPARTMENT
 255 West Riverview Avenue, Napoleon, Ohio 43545 - 419-592-4010

Permit No. 175-788 Issued 10-11-78
date

Job Location 1215 Glenwood Ave.
address

Lot 1 Christ U.M.C. Sub. Div.
sub-div or legal discript

Issued By R.E. Johnson
building official

Owner Keith & Karen Peglar 599-3590
name tel.

Address 1215 Glenwood Ave.

Agent Self
builder-eng.-etc. tel.

Address _____

Description of Use Install wood burning stove

Residential one
no. dwelling units

Commercial _____ Industrial _____

New _____ Add'n. _____ Alter _____ Remodel xxx

Mixed Occupancy _____

Change of Occupancy _____

Estimated Cost \$ 1,000.00

| FEES | BASE | PLUS | TOTAL |
|--|-------------------------|------|---------------------|
| <input checked="" type="checkbox"/> BUILDING | \$6.00 | | \$6.00 |
| <input type="checkbox"/> ELECTRICAL | | | |
| <input type="checkbox"/> PLUMBING | | | |
| <input type="checkbox"/> MECHANICAL | | | |
| <input type="checkbox"/> DEMOLITION | | | |
| <input type="checkbox"/> ZONING | | | |
| <input type="checkbox"/> SIGN | | | |
| WATER TAP | | | |
| SEWER TAP | | | |
| TEMP. ELECT. | | | |
| ADDITIONAL PLAN REVIEW | Struct. _____ hrs _____ | | |
| | Elect. _____ hrs _____ | | |
| TOTAL FEES..... | | | \$6.00 |
| LESS MIN. FEES PAID _____ | | | 0 |
| | | | <small>date</small> |
| BALANCE DUE..... | | | \$6.00 |

ZONING INFORMATION

n/a

| district | lot dimensions | area | front yd | side yds | rear yd |
|----------|----------------|---------------|-----------|--------------------------|-----------|
| max hgt | no pkg spaces | no ldg spaces | max cover | petition or appeal req'd | date appr |

WORK INFORMATION:

Size: Length _____ Width _____ Stories _____ Ground Floor Area _____

Height _____ Building Volume (for demo. permit) _____ cu. ft.

Electrical: _____
brief description

Plumbing: _____
brief description

Mechanical: _____
brief description

Sign: _____ Dimensions _____ Sign Area _____
type

PAID
 OCT 13 1978
 CITY OF NAPOLEON

Additional Information: CALL FOR FINAL INSPECTION WHEN COMPLETE: Extend chimney 2' higher than any part of the building within 10'.

Date 10/13/78 Applicant Signature Karen R. Peglar
owner-agent

BK

175-78

CITY OF NAPOLEON
BUILDING INSPECTION DEPARTMENT
APPLICATION FOR CONSTRUCTION PERMIT
(PLEASE PRINT OR TYPE)

600

The undersigned hereby makes application for the construction, installation, replacement or alteration as herein specified, agreeing to do all such work in strict accordance with the City of Napoleon's Building Code for 1, 2 and 3 Family Buildings.

Owner's Name Karen-Keith Peglar Address 1215 Glenwood

Builder's Name Same Address Same Tel. 599-3590

LOT INFORMATION: (Not required for roofing or siding job.)

Location of Project Same as above Lot# _____

Subdivision _____ Lot Area _____ Sq. Ft. _____

Yard Setback: Front _____ Rear _____ Left Side _____

Right Side _____ Zoning District _____

BUILDING INFORMATION:

Single _____ Double _____ Multiple _____ New Construction _____

Addition _____ Remodel _____ Attached Garage _____

Detached Garage _____ Accessory Building _____ Replacement _____

Brief Description of Work: to install ^{fire proof} hearth and rear wall for wood-burning stove -^{also} chimney for stove

Size: Length _____ Width _____ No. of Stories _____

Floor Area: 1st Floor _____ Sq. Ft. 2nd Floor _____ Sq. Ft.

3rd Floor _____ Sq. Ft. Basement _____ Sq. Ft.

Unfinished Attic _____ Garage _____

Foundation: Piers _____ Full Basement _____ Part Basement _____

Concrete _____ Thickness _____ Block _____ Size _____

Walls: Frame _____ Block _____ Brick _____ Other _____

Specific Type of Exterior Siding _____

APPLICATION FOR PERMIT SHALL BE ACCOMPANIED BY TWO COMPLETE SETS OF PLANS INCLUDING: ELEVATIONS, FLOOR PLANS, CROSS SECTIONS AND PLOT PLAN. IF ADDITIONS OR REMODELING, SHOW ALL EXISTING STRUCTURE AND THEIR SIZE AND LOCATION. ALL PLANS SHALL BE DRAWN TO SCALE.

ESTIMATED COST OF COMPLETED PROJECT: \$1000

DATE 10/10/78 APPLICANT'S SIGNATURE Karen Peglar
OWNER-BUILDER-AGENT

wood/coal heater

THE BELGIAN



by
Southport Stoves

owner's guide

Wood/Coal
Heater
and
Fireplace
Combination

K.P. Reglan

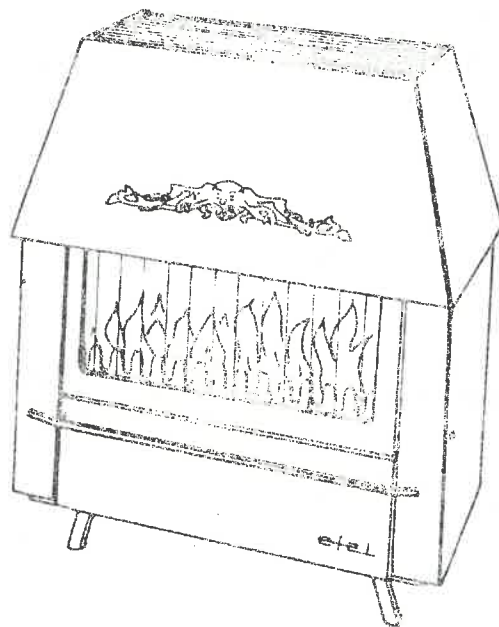

ASSEMBLY

1. Raise top cover.
2. Place glass door in open position. Then lower top cover to retain the glass door in the open position.
3. Remove flue collar from combustion chamber.
4. Lift out grate assembly.
5. Open ash compartment door and remove ash pan containing legs, bolts, asbestos cord and service tool.
6. Lay heater on its back and attach legs with bolts, nuts and washers provided.
7. Place heater upright. Install grate assembly and ash pan.
8. Attach flue collar to flue discharge using the asbestos cord and six screws.

Your EFEL Wood Heater is carefully built to give you the best possible service and satisfaction. Complete success with your Wood Heater depends primarily on the following:

proper assembly and installation
a good chimney draft
proper firing

daily removal of ashes
keeping chimney free of soot
avoid overheating



INSTALLATION

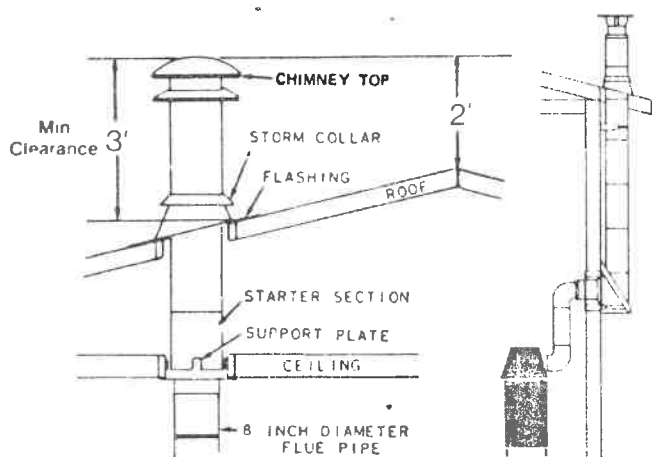

FIG 1

NOTE: Local building codes and regulations must be adhered to in all heater installations. Check those in your area.

1. Install the crimped end of the first section of the flue pipe into the flue collar.
2. Assemble the remaining section of the flue pipe.
3. The flue pipe section at the chimney entrance must be crimped to fit.
4. Furnace cement the joints at the flue collar and at the chimney entrance.
5. Connect your Wood Coal Heater to a class "A" chimney — 8 inch inside diameter. (Class "A" chimneys are those built or lined with brick, cement or tile and UL listed.) A UL listed 8 inch pre-fabricated chimney can also be used when installing heaters.

Chimney must have normal draft. The top must be high enough so as not to be restricted by overhanging tree tops or nearby taller buildings. Both will tend to create down drafts under certain wind conditions. Secure flue pipe to heater flue collar with screw through hole provided. (This pipe must comply with local codes and regulations.) For best results, horizontal flue pipe should be kept to a minimum and an upward slant of at least 1/4 inch per foot of pipe be maintained. (Fig. 1).

6. Check chimney to see that it is clean and free of all obstructions, such as soot, mortar and bricks.
7. If possible, set your heater directly in front of the chimney to be used. In this way, the pipe connection to the flue can be made with the minimum of elbows.

THE FOLLOWING MINIMUM CLEARANCES TO WALLS SHOULD BE ADHERED TO IN ALL INSTALLATIONS:

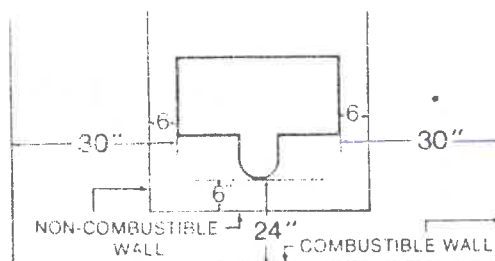

BACK: 6 inches from NON-COMBUSTIBLE wall to back of unit.
24 inches from COMBUSTIBLE wall to back of unit.

SIDES: 6 inches from NON-COMBUSTIBLE wall to the side of the unit.
30 inches from COMBUSTIBLE wall to side of the unit.

WARNING: The entire non-combustible wall must be constructed of non-combustible materials and not consist of veneer applied on wood framing.

FLOOR: The floor covering should extend at least 20 inches in front of the unit, 12 inches from the side of the unit and should be of non-combustible material (stone, brick, tile or slate) which is 3/8-inch thick.

8. Do not insert the flue pipe too far into the flue opening. The flue pipe should not extend into the flue opening beyond the inside chimney wall.

IF HEATER SMOKES OR DOES NOT HEAT, CHECK THE FOLLOWING:

1. Insufficient chimney draft. This may be due to restriction or clogging of chimney itself — or possibly a tree branch may be covering the chimney outlet. Remedy by removing the clogging or trimming the tree branch.
2. Flue pipe inserted too far into chimney flue opening. Flue pipe should not extend into the chimney beyond the inside wall.
3. Pipe obstructed with soot. Remedy by removing the soot obstruction.
4. More than one flue connected to chimney with flue openings directly opposite. Remedy by raising or lowering one flue opening.
5. Incorrect operation of damper. When adding fuel to fire, make sure that the damper in fireplace is open.
6. A low chimney top outlet or overhanging trees may cause downdrafts. Remedy by making certain chimney outlet is not restricted.

WATERPROOF
MASTIC

4 1/2 ft high

PITCH 4/12

K. Peglar
1215 Glenwood
599-3590

37"
↑

Dog ear
Stone

58

95 3/4

37 3/4 to top
of back vent

Etel

0.0

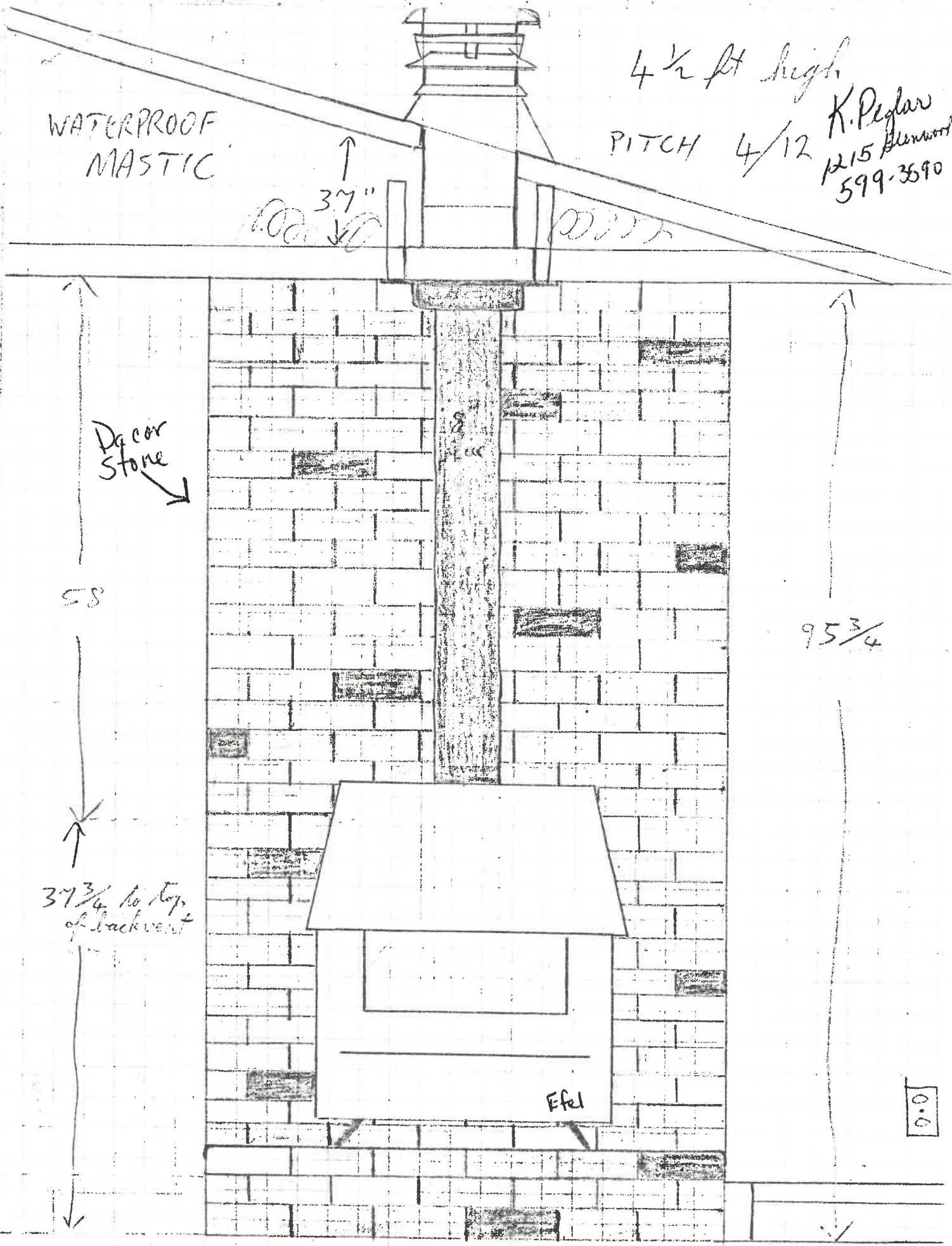

| | |
|------------------|-----------------------|
| TOP | $6 \times 15 = 90$ |
| FRONT | $6 \times 2 = 12$ |
| EDGE | $6 \times 3 = 18$ |
| INT | $5 \times 3 + 1 = 16$ |
| SHT | $5 \times 3 + 1 = 16$ |
| CONT | $6 \times 3 = 18$ |
| | <u>170</u> bricks |

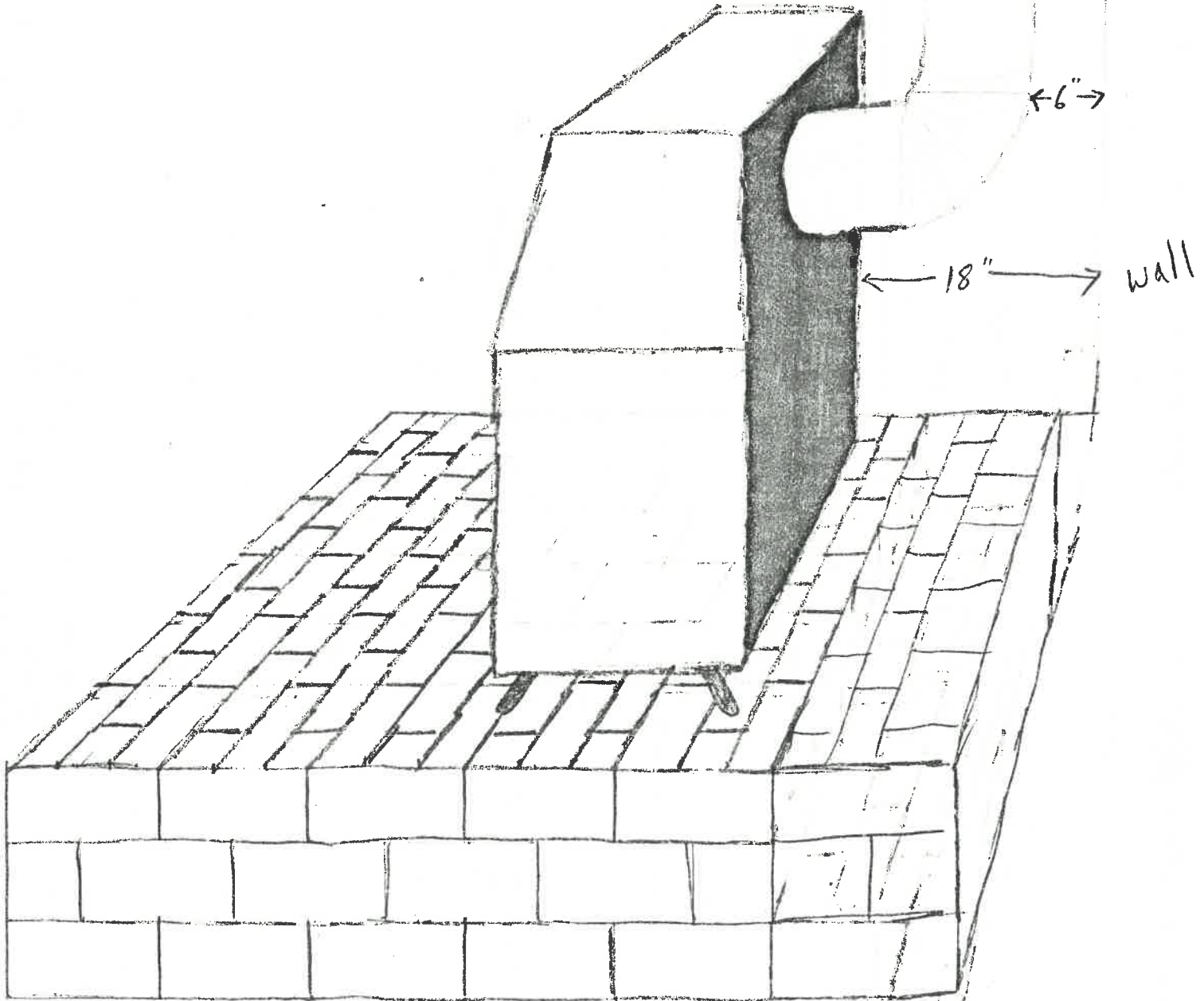

- 1 @ ~~5" x 4 1/2" PLYWOOD~~
- 1 @ ~~5" x 8" PLYWOOD~~
- 1 @ ~~5" x 4 1/2" ASBESTOS~~
- 1 @ ~~5" x 8" ASBESTOS~~
- 1 @ ~~5" x 2" PLYWOOD~~

15" x 20" x 5"

CASE

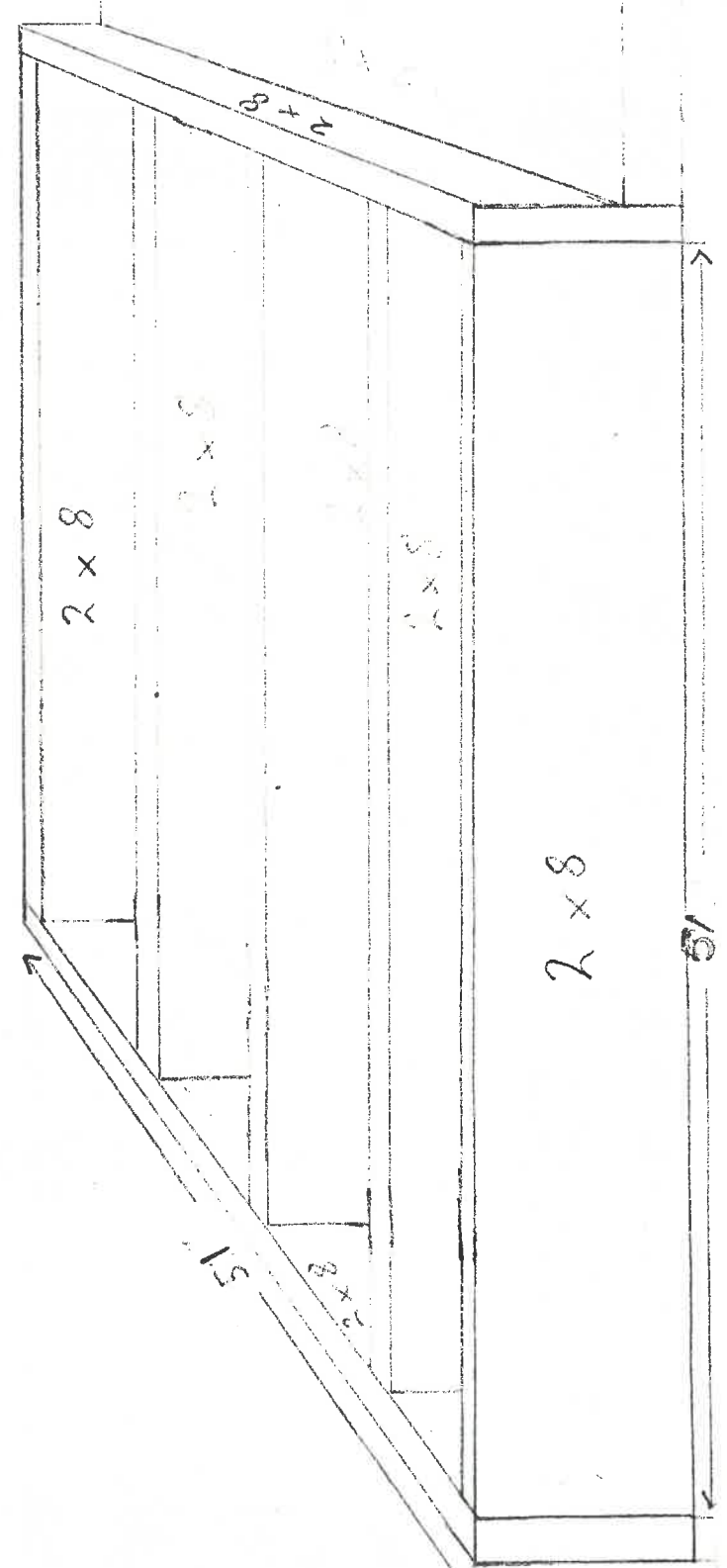
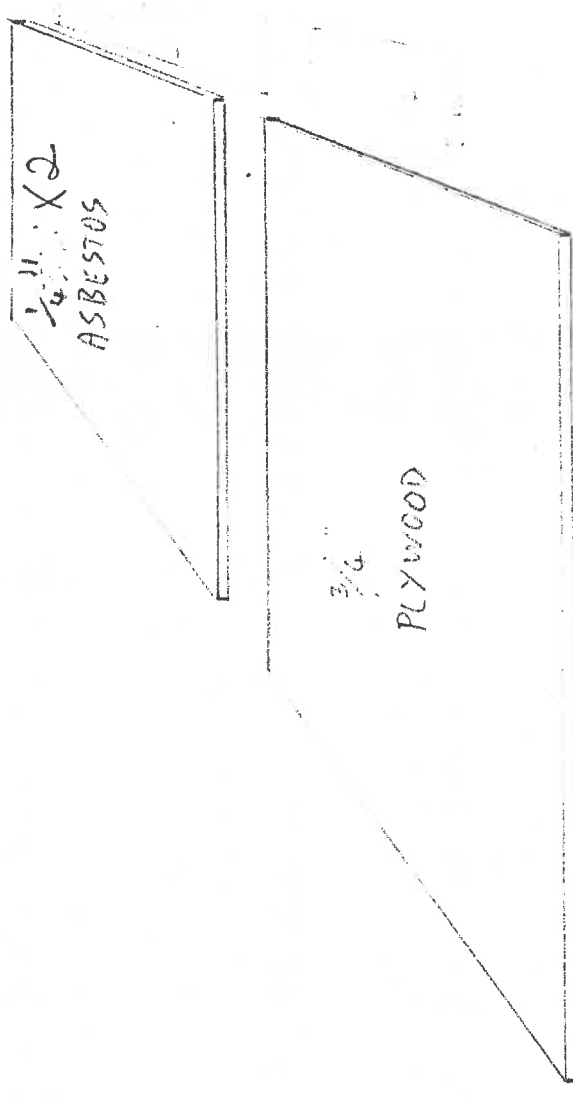

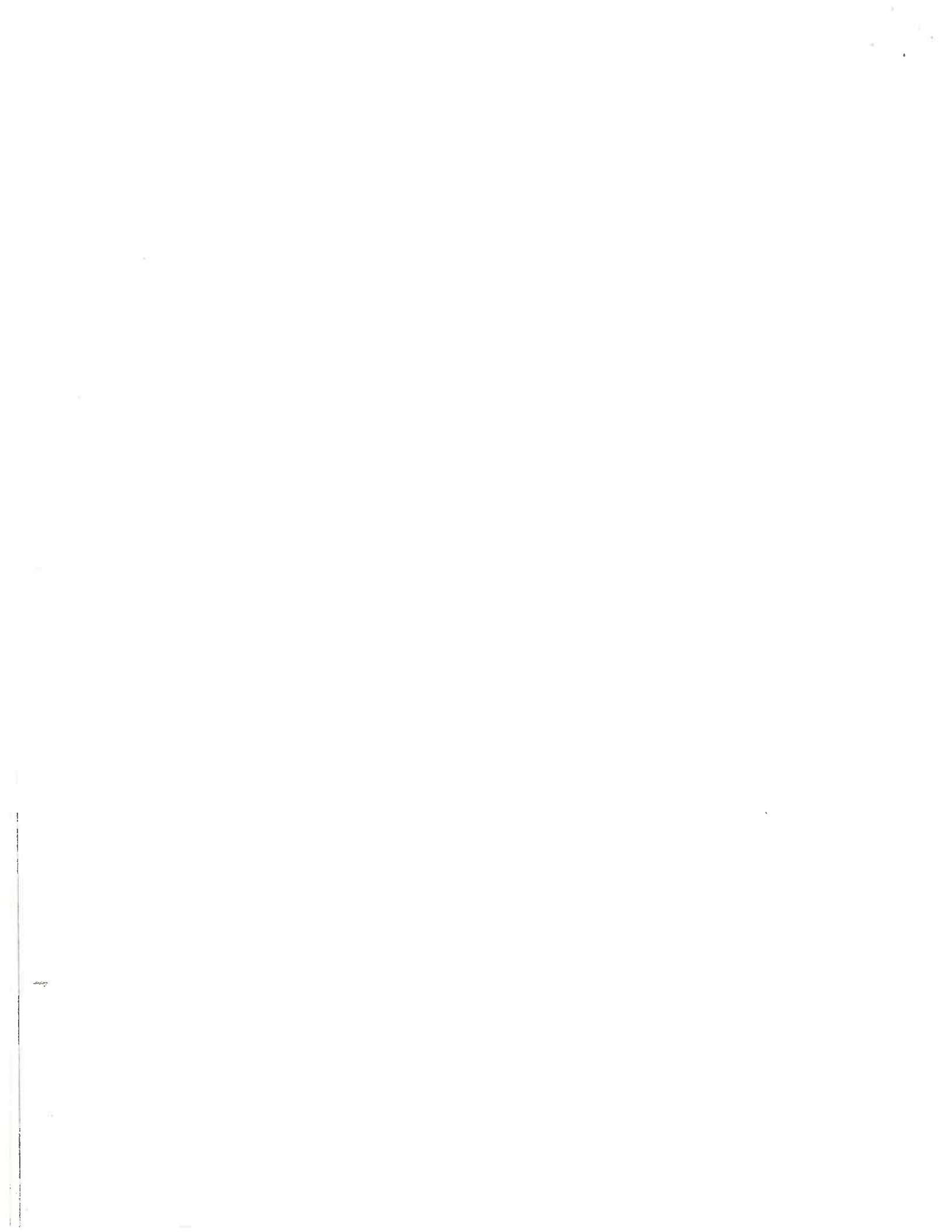

~~1 @ 51 x 88 1/2 PL WOOD~~
~~1 @ 51 x 88 1/2 ASBESTOS~~

48

BACK

