

**CITY OF NAPOLEON
BUILDING CONSTRUCTION PERMIT
(1, 2 or 3 Family Dwelling)**

Owner Name James E. Huff

Address 410 ~~2622 E. 3200~~ (Huddle Road)

Builder Name Self

Address Same Tel. 592-4218

Lot Information:

Street No. Rt. 1, Box 320D (Huddle Road)

Lot Subdivision

Lot Dimensions Lot Area Sq. Ft.

Yard Set Back: Front Rear Min. 15'

One Side Min. 5' Side

Zoning "A" Intended use of Building: Constructing to the rear of the existing dwelling a wood frame patio roof cover.

Building Information: Note: Existing conc. slab.

Single Double Multiple New Construction Addition Remodel

Size: Length 28' Width 12' No. of Stories 1

Floor Area: 1st Floor 2nd Floor 3rd Floor Basement

Unfinished Attic Garage

Foundation: Piers 12" x 12" Full Basement Part Basement

Concrete Block

Walls: Frame Block Brick Other

Electrical: Wiring None Electric Heating --- Electrical Appliances ---

Plumbing: Fixtures or Traps Warm Air Heating Hot Water Heating

Additional Information: This permit requires compliance with the attached letter No. 328-751 and the attached addendum marked exhibit "A" and made a part here-of.

Date 7-11-75 Applicant Signature James E. Huff

Owner - Builder - Agent

Note: 9/9/75 unable to locate side lotline markers, but reasonable sure 5' side setback provided. P.W.P.

Inspection Record:

Work Started Foundations Plumbing, Heating

Set Back, Side Lines Plumbing (Rough In) And Air Conditioning

Excavation Erecting Frame Roof

Footing Electrical Work

Comments: 9/9/75 work completed, inspected by P.W.P.

Certificate of Occupancy Issued

Pink - Engineer

Inspector

| | | | |
|-----------------|--|-----------------------------|-----------------------------|
| Permit No. | <u>328-75</u> | | |
| Issued | <u>7/20/75</u> | | |
| By | <u>Thomas W. Branson</u> Building Inspector | | |
| Valuation | <u>\$300.00</u> | | |
| | Fees | Base | Plus |
| Construction | <u>\$3.00</u> | <u>--</u> | <u>\$3.00</u> |
| Plumbing | <u> </u> | <u> </u> | <u> </u> |
| Electrical | <u> </u> | <u> </u> | <u> </u> |
| Heating | <u> </u> | <u> </u> | <u> </u> |
| Water Tap | <u> </u> | <u> </u> | <u> </u> |
| Sewer Tap | <u> </u> | <u> </u> | <u> </u> |
| Temporary Elec. | <u> </u> | <u> </u> | <u> </u> |
| TOTAL | <u>\$3.00</u> | <u>--</u> | <u>\$3.00</u> |

CITY OF NAPOLEON
Engineering Department
255 Riverview Avenue
NAPOLEON, OHIO 43545

| | | | |
|--|----------------------------------|---------|--------------------------------|
| DATE | July 10, 1975 | JOB NO. | Permit No. 328-75 |
| PROJECT | 12' X 28' Wood Frame Ratio Cover | | |
| LOCATION | Huddle Road. | | |
| CONTR. BY | Self | OWNER | HUFF |
| WEATHER | _____ | TEMP. | ° at _____ AM ° at _____ PM |
| PREPARED AT SITE | | | |
| CITY OF NAPOLEON ENGINEERING DEPT. PLAN APPROVAL BY: <u>P.P.</u> DATE: <u>7-10-75</u> | | | |

TO James E. Huff

Huddle Road

Napoleon, Ohio 43545

Addendum To Plan Approval

THE FOLLOWING WAS NOTED:

During plan review and requires compliance with the City's adopted codes:

- 1) Because of span of girder you must provide a 4" X 4" post every 9'-4" o/c and use a double 2" X 6" for wood girder supporting the roof system. Table No. 4-B of B.C.A. Code.
- 2) Roof rafters max. span of 2' o/c for 2" X 6" rafters. Table No. 7-L
- 3) Provide a wood hanger or joist hangers under roof rafters to support roof system properly.

Completed as required. July 9/75

Any questions feel free to contact me.
Phone No. 592-4010

COPIES TO Mr. Huff & on record
with Bldg. Permit No. 328-75

Letter No. 328-75L
FIELD REPORT

SIGNED Thomas W. Sienora
Building Inspector



City of NAPOLEON, OHIO

255 RIVERVIEW AVENUE — (419) 592-4010

Mayor
Robert G. Heft

Clerk-Treasurer
Rupert W. Schweinhagen

Members of Council
Vern Holers, President
Lawrence Haase
James Jackson
Marilyn Rausch
David Strobel
William Young

City Manager
Alan E. Tandy

Law Director
Keith Muehlfeld

Mr. J
410 H
Napol

2 X 6 rafters 16" centers
4 X 4 Posts 7'
2 2 X 8 Beams

Jim Kluff

Call at noon any day
592-6248

Dear

We have
for ne
areas
numer
this
north,
the nu
number
using
with r
must b

An ord
respon
Fire a
for th
place
will a
theref
and pr
approp
seen f

We do
the ne
forms.
new pr
includ

If you
system

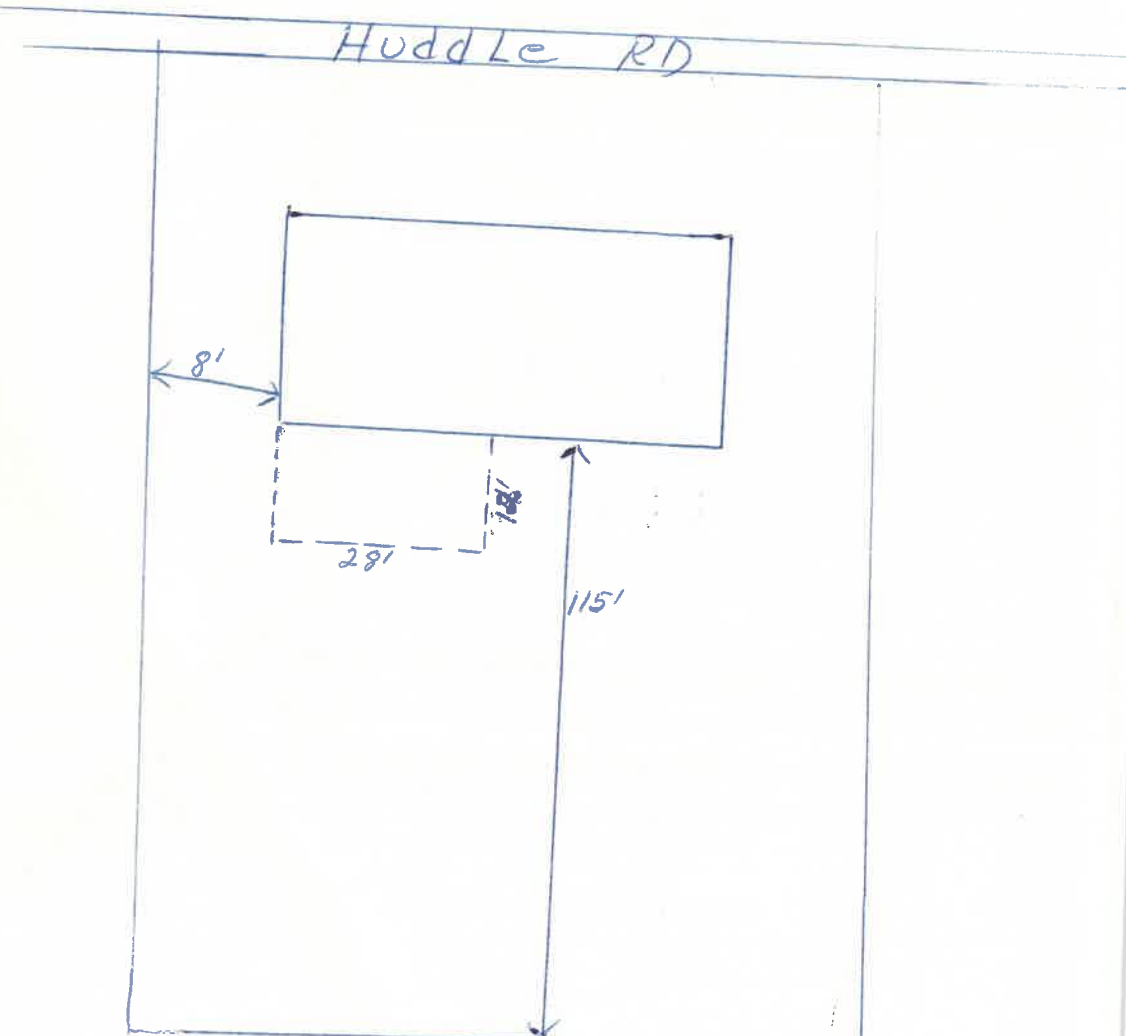

1
2
3
4
5
6
7
8
9
10
11
12
13
14
15
16
17
18
19
20
21
22
23
24
25
26
27
28
29
30
31
32
33
34
35
36
37
38
39
40
41
42
43
44
45
46
47
48
49
50
51
52
53
54
55
56
57
58
59
60
61
62
63
64
65
66
67
68
69
70
71
72
73
74
75
76
77
78
79
80
81
82
83
84
85
86
87
88
89
90
91
92
93
94
95
96
97
98
99
100