

CITY OF NAPOLEON GENERAL PERMIT APPLICATION

THIS APPLICATION IS FOR RESIDENTIAL CONSTRUCTION INCLUDING BUILDING, ELECTRICAL, PLUMBING, MECHANICAL & REMODELING

P-16-019

DATE 4-26-2016 JOB LOCATION 1155 Kenilworth Ave
 OWNER Mary Eickhoff TELEPHONE # 419 438 5411
 OWNER ADDRESS 1155 Kenilworth Ave
 CONTRACTOR AO Contracting LLC CELL PHONE # 419 204 0126
 DESCRIPTION OF WORK TO BE PERFORMED low level Deck 10x16

ESTIMATED COMPLETION DATE 4-28-2016 ESTIMATED COST 500.00

Affected Floor Area (AFA): In existing structures, it is the area affected by the improvement, i.e. a new wall dividing a room (the AFA would be only the room and not all the rooms).

| DESCRIPTION | FEE | TOTAL COST |
|--|---------|---------------|
| BUILDING: | | |
| <i>Decks</i> | \$25.00 | \$ 25.00 |
| <i>Addition & Alterations</i> Square foot in (AFA) x \$0.05 = \$ | + | \$25.00 = \$ |
| Garage and Shed over 200 SF (Detached) | \$25.00 | \$ |
| Siding and/or Roofing | \$25.00 | \$ |
| Windows/Doors | \$25.00 | \$ |
| ELECTRICAL: | | |
| <i>Electrical</i> Circuits in (AFA) x \$3.00/Circuit = \$ | + | \$25.00 = \$ |
| Electrical Service Upgrade | \$25.00 | \$ |
| MECHANICAL: | | |
| Water Heater | \$25.00 | \$ |
| Furnace and/or AC Replacement | \$25.00 | \$ |
| PLUMBING: | | |
| <i>Plumbing</i> Traps in (AFA) x \$3.00/Trap = \$ | + | \$25.00 = \$ |
| TOTAL plus Ohio Board of Building Standards Fee 1% | | \$ 250 |

TOTAL FEE: \$ 250

I FULLY UNDERSTAND THAT NO EXCAVATION, CONSTRUCTION OR STRUCTURAL ALTERATION, ELECTRICAL OR MECHANICAL INSTALLATION OR ALTERATION OF ANY BUILDING STRUCTURE, SIGN, OR PART THEREOF AND NO USE OF THE ABOVE SHALL BE UNDERTAKEN OR PERFORMED UNTIL THE PERMIT APPLIED FOR HEREIN HAS BEEN APPROVED AND ISSUED BY THE CITY OF NAPOLEON BUILDING/ZONING DEPARTMENT.

I hereby certify that I am the Owner of the named property, or that the proposed work is authorized by the Owner of record and that I have been authorized by the Owner to make this application as his/her authorized agent and I agree to conform to all applicable laws of the jurisdiction. In addition, if a permit for Work described in this application is issued, I certify that the code official or the code official's authorized representative shall have the authority to enter areas covered by such permit at any reasonable hour to enforce the provisions of the code(s) applicable to such permit.

I HEREBY ACKNOWLEDGE THAT I HAVE READ AND FULLY UNDERSTAND THE ABOVE LISTED INSTRUCTIONS.

SIGNATURE OF APPLICANT: [Signature] DATE: 4-26-2016
 PRINT NAME: Aaron Estey

BATCH # 34143 CHECK # 1034 DATE 4-27-16

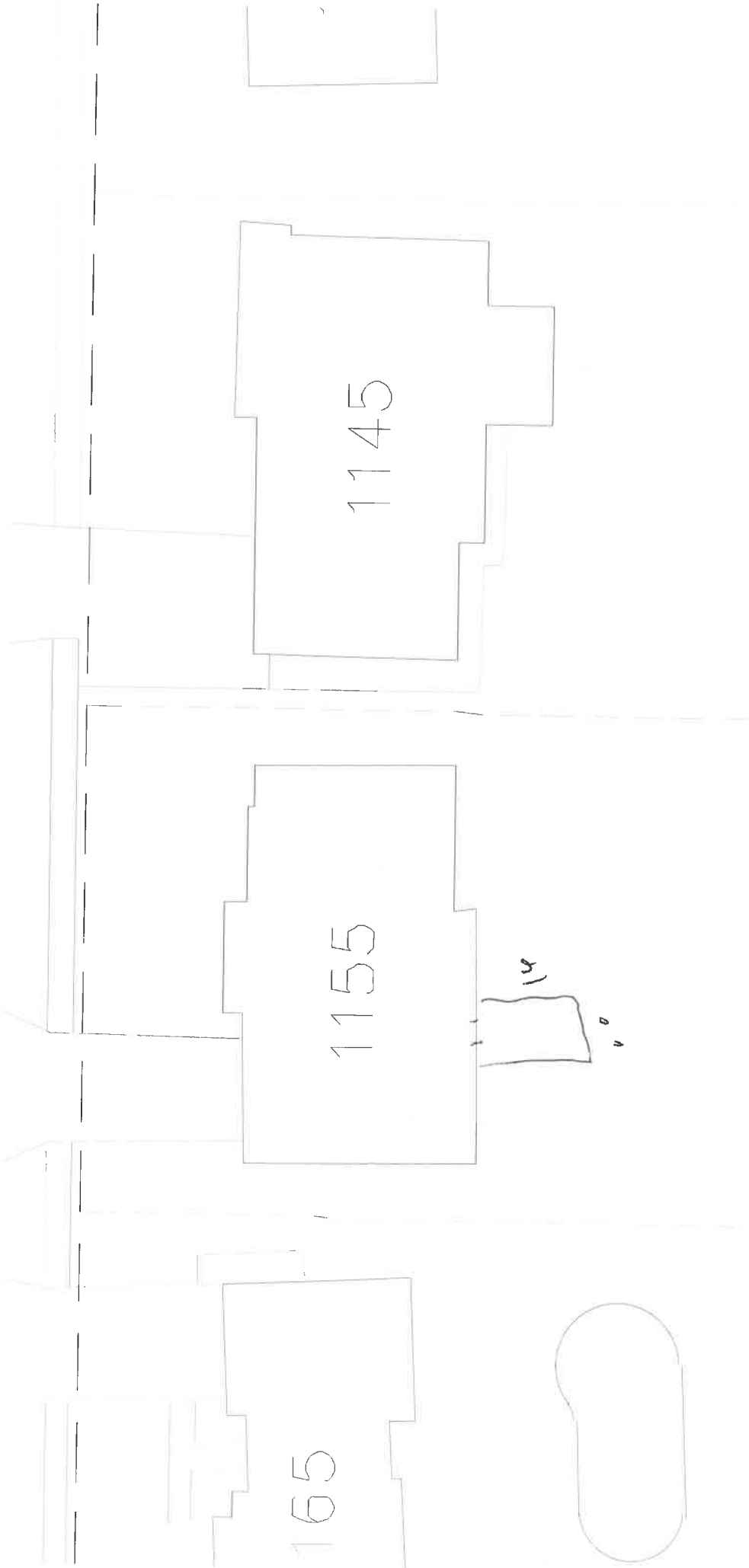

165

1155

1145

14

