

THE CITY OF NAPOLEON

BUILDING & ZONING DEPARTMENT

255 W. RIVERVIEW

(419) 592-4010

Building Permit

Permit Number: BP2008-161

Page 1 of 1

Printed: 9/9/2008

ADDRESS:

1055 Kenilworth Ave.

Applicant

Name: Strait-Line Fencing
Address: 06651 State Route 15

Approval Date: 9/3/2008
419-633-3367

Owners

Name: Mr. Jeff & Carrie Moore
Address: 1055 Kenilworth Ave
Napoleon, OH 43545

Phone: 419-599-2220

Contractors

Contractor Type: Other

Name: Strait-Line Fencing
Address: 06651 State Route 15

Bryan, OH 43506

Phone: 419-633-3362

Fees and Receipts:

Number	Description	Amount
FEE2008-578	Building Permit Fee (Auto)	\$18.00
FEE2008-579	State 1% fee (Calc)	\$0.18
Total Fees:		\$18.18
RCPT2008-360		\$18.18
Total Receipts:		\$18.18

6' privacy fence

APPLICANTS SIGNATURE: _____ DATE: _____

REMINDER: YOU MUST CALL (419)592-4010 FOR AN INSPECTION

BPO8-121

8 18 18

CITY OF NAPOLEON GENERAL PERMIT APPLICATION

THIS APPLICATION IS FOR RESIDENTIAL CONSTRUCTION INCLUDING BUILDING, ELECTRICAL, PLUMBING, MECHANICAL, DEMOLITIONS, REMODELING.

DATE: 9-2-08 JOB LOCATION: 1055 Kenilworth Ave

OWNER: Carmie Moore PHONE: 419 599-2220

OWNER ADDRESS: _____ CITY: _____ ZIP: _____

CONTRACTOR: Strait Line Fencing

PHONE #: 419 633-3307 CELL PHONE#: 419 576-0386

CONTRACTOR LICENSED WITH THE CITY OF NAPOLEON?: YES NO:

Is any of the above job going to be subcontracted out? Yes No:

If yes to whom: _____

DESCRIPTION OF WORK TO BE PERFORMED: 6' high vinyl Privacy Fence

ESTIMATED COMPLETION DATE: 9-10-08

PLEASE MARK THE TYPE OF WORK YOU WILL BE PERFORMING

- | | |
|---|---|
| <input type="checkbox"/> A/C ADD ON | <input type="checkbox"/> REMODELING |
| <input type="checkbox"/> BOILER REPLACEMENT | <input type="checkbox"/> ROOFING |
| <input type="checkbox"/> CURBING | <input type="checkbox"/> SEWER REPAIRS** |
| <input type="checkbox"/> DECKS * | <input type="checkbox"/> SIDEWALK* |
| <input type="checkbox"/> DRIVEWAY* | <input type="checkbox"/> SIDING |
| <input type="checkbox"/> ELECTRICAL SERVICE UPGRADE | <input type="checkbox"/> STORAGE SHED* |
| <input type="checkbox"/> ELECTRICAL SERVICE NEW | <input type="checkbox"/> SWIMMING POOL* |
| <input checked="" type="checkbox"/> FENCE* | <input type="checkbox"/> FURNACE REPLACEMENT |
| <input type="checkbox"/> ADDITIONS* | <input type="checkbox"/> TEMP ELECTRIC |
| <input type="checkbox"/> FURNACE NEW | <input type="checkbox"/> WATER TAP (size _____) |
| <input type="checkbox"/> LAWN METER | <input type="checkbox"/> WINDOWS |
| <input type="checkbox"/> PLUMBING | <input type="checkbox"/> ZONING |

*PLEASE INCLUDE A PICTURE SHOWING MEASUREMENTS FROM EXISTING STRUCTURES AND PROPERTY LINES. INDICATING THE TYPE OF WORK YOU WISH TO PERFORM.

** IF WORK REQUIRES GOING INTO THE STREET A STREET BOND IS REQUIRED!

FOR PERMIT COSTS PLEASE FILL OUT REVERSE SIDE.

PERMIT COST WORKSHEET

<u>JOB</u>	<u>BASE FEE</u>	<u>TOTAL</u>
SIDING (only) TOTAL SQ ____ X 1.00 +	\$5.00 =	\$ _____
ROOFING (only) TOTAL SQ ____ X 1.00 +	\$5.00 =	\$ _____
WINDOWS / DOORS(only) # ____ X 1.00 +	\$5.00 =	\$ _____
ELECTRICAL # OF CIRCUITS ____ X 3.00 +	\$15.00 =	\$ _____
ELECTRICAL SERVICE UPGRADE	\$15.00 =	\$ _____
PLUMBING (INSIDE) replacing/ repairs	\$10.00 =	\$ _____
SEWER (OUTSIDE)	\$25.00 =	\$ _____
WATER HEATER	\$5.00 =	\$ _____
SHED UNDER 200 SQ FT (over 200 see chart)	\$ 5.00 =	\$ _____
FURNACE OR A/C (REPLACEMNT)	\$ 5.00 =	\$ _____
DEMOLITION (only)	\$30.00 =	\$ _____
SIDEWALK REPLACEMENT/ NEW	\$25.00 =	\$ _____
DRIVEWAY	\$25.00 =	\$ _____

ALL CONSTRUCTION, ALTERATIONS, REMODELING, SHEDS, DECKS & FENCES NOT LISTED ABOVE IS BASED ON COST OF WORK BEING PERFORMED.

COST OF WORK \$ 4,150 (SEE CHART) \$ 18⁰⁰

0.00 -	250.00	0.00	11,000.00 -	11,999.00	25.00
250.00 -	1,000.00	10.00	12,000.00 -	12,999.00	26.00
1,000.00 -	1,999.00	12.00	13,000.00 -	13,999.00	27.00
2,000.00 -	2,999.00	14.00	14,000.00 -	14,999.00	28.00
3,000.00 -	3,999.00	16.00	15,000.00 -	15,999.00	29.00
4,000.00 -	4,999.00	18.00	16,000.00 -	16,999.00	30.00
5,000.00 -	5,999.00	19.00	17,000.00 -	17,999.00	31.00
6,000.00 -	6,999.00	20.00	18,000.00 -	18,999.00	32.00
7,000.00 -	7,999.00	21.00	19,000.00 -	19,999.00	33.00
8,000.00 -	8,999.00	22.00	20,000.00 -	20,999.00	34.00
9,000.00 -	9,999.00	23.00	21,000.00 -	21,999.00	35.00
10,000.00 -	10,999.00	24.00	22,000.00 -	22,999.00	36.00
			Over 22,999	Please Call	

*OTHER FEES NOT LISTED MAY APPLY

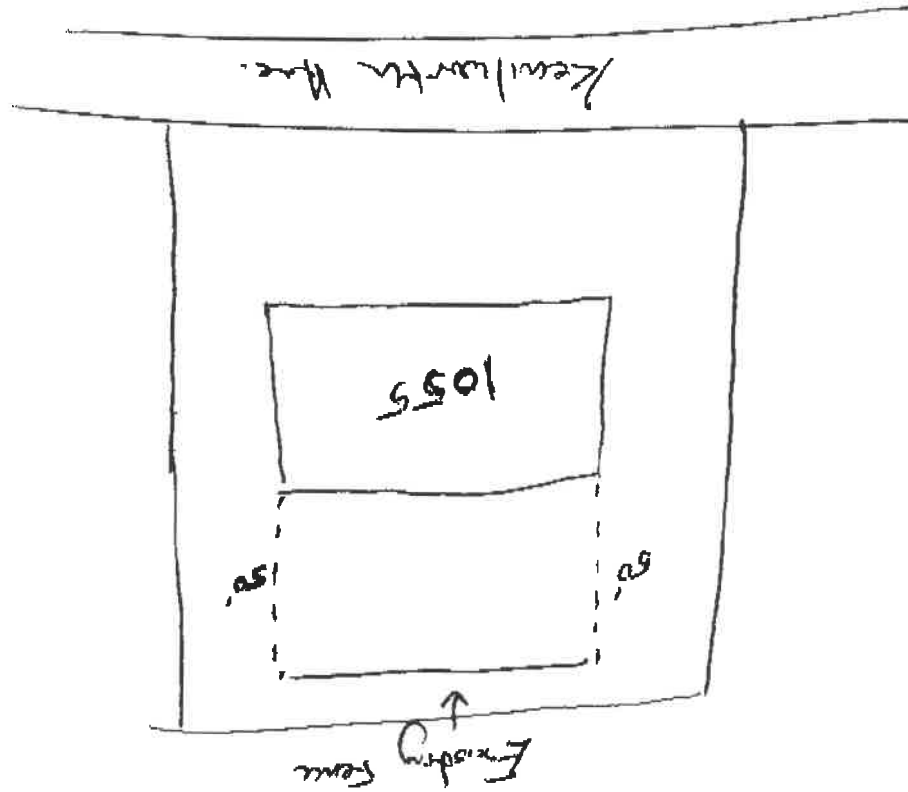

----- = 6' high Vinyl Privacy Fence

