

PERMIT

CITY OF NAPOLEON - BUILDING DEPARTMENT

255 West Riverview Avenue, Napoleon, Ohio 43545 - 419-592-4010

Permit No. 01999 Issued 6-7-90
date

Job Location 265 Northcrest Drive
address

Lot 26 Northcrest Add.
sub-div or legal discript

Issued By Eldon Huber
building official

Owner Jr. Schroeder 599-0393
name tel.

Address 265 Northcrest Drive

Agent Self
builder-eng.-etc. tel.

Address _____

Description of Use Residence

Residential 1
no. dwelling units

Commercial _____ Industrial _____

New X Add'n. _____ Alter _____ Remodel _____

Mixed Occupancy _____

Change of Occupancy _____

Estimated Cost \$ 500.00

FEES	BASE	PLUS	TOTAL
<input checked="" type="checkbox"/> BUILDING	9.00	.00	9.00
<input type="checkbox"/> ELECTRICAL			
<input type="checkbox"/> PLUMBING			
<input type="checkbox"/> MECHANICAL			
<input type="checkbox"/> DEMOLITION			
<input type="checkbox"/> ZONING			
<input type="checkbox"/> SIGN			
<input type="checkbox"/> WATER TAP			
<input type="checkbox"/> SEW. INSP.			
<input type="checkbox"/> SEWER TAP			
<input type="checkbox"/> TEMP. WATER			
<input type="checkbox"/> TEMP. ELECT.			
ADDITIONAL PLAN REVIEW	Struct. _____ hrs	Elect. _____ hrs	
TOTAL FEES.....			9.00
LESS MIN. FEES PAID _____			
BALANCE DUE.....			

ZONING INFORMATION

district	lot dimensions	area	front yd	side yds	rear yd
A	85' x 120'	10,200	85'	L-5' R-	10'
max hgt	no pkg spaces	no ldg spaces	max cover	petition or appeal req'd	date appr

WORK INFORMATION:

Size: Length 25' 01A Width _____ Stories _____ Ground Floor Area 471

Height _____ Building Volume (for demo. permit) _____ cu. ft.

Electrical: direct burial cable to existing outdoor circuit
brief description

Plumbing: _____
brief description

Mechanical: _____
brief description

Sign: _____ Dimensions _____ Sign Area _____
type

Additional Information: above ground pool Note: all metal parts & electrical equip. shall be grounded, provide a smoke detector in the house if there are none existing. **PAID**

Date 6/7/90 Applicant Signature JR Schroeder owner-agent **CITY OF NAPOLEON**
 JUN 07 1990

INSPECTION RECORD

UNDERGROUND			ROUGH-IN						FINAL		
Type	Date	By	Type	Date	By	Type	Date	By	Type	Date	By
PLUMBING	Building Drains		Drainage, Waste & Vent Piping			Indirect Waste			Drainage, Waste & Vent Piping		
	Water Piping								Backflow Prevention		
	Building Sewer		Water Piping			Condensate Lines			Water Heater		
	Sewer Connection								FINAL APPROVAL		
MECHANICAL	Refrigerant Piping		Refrigerant Piping			Chimney(s)			Grease Exhaust System		
			Duct Furnace(s)			Fire Dampers			Air Cond. Unit(s)		
	Ducts/Plenums		Ducts/Plenums			<input type="checkbox"/> Radiant Htr(s) <input type="checkbox"/> Unit Htr(s)			Refrigeration Equipment		
			Duct Insulation			Pool Heater			Furnace(s)		
			Combustion Products Vents			Ventilation <input type="checkbox"/> Supply <input type="checkbox"/> Exhst.			FINAL APPROVAL		
ELECTRICAL	Conduits & or Cable		Conduits/ Cable			<input type="checkbox"/> Range <input type="checkbox"/> Dryer			Temp Service Temp Lighting		
	Grounding & or Bonding		Rough Wiring			<input type="checkbox"/> Generator(s) <input type="checkbox"/> Motors			Fixtures Lampholders		
	Floor Ducts Raceways		Service Panel Switchboard			<input type="checkbox"/> Water Htr <input type="checkbox"/> Welder			Signs		
	Service Conduit		Busways Ducts			<input type="checkbox"/> Heaters <input type="checkbox"/> Heat Cable			Electric Mtr. Clearance		
	Temporary Power Pole		Subpanels			<input type="checkbox"/> Duct Htr(s) <input type="checkbox"/> Furnace(s)			FINAL APPROVAL		
BUILDING	Location, Set-backs, Esmt(s)		Exterior Wall Construction			Roof Covering Roof Drainage			Smoke Detector		
	Excavation					Exterior Lath			Demolition (sewer cap)		
	Footings & Reinforcing					<input type="checkbox"/> Interior Lath <input type="checkbox"/> Wallboard					
	Floor Slab		Interior Wall Construction			Fire Wall(s)			Building or Structure		
	Foundation Walls		Columns & Supports			Fireplace Chimney					
	Sub-soil Drain		Crawl Space <input type="checkbox"/> Vent <input type="checkbox"/> Access			Attic <input type="checkbox"/> Vent <input type="checkbox"/> Access					
	Piles		Floor System(s)						FINAL APPROVAL BLDG. DEPT.	7/12	BD
			Roof System			Special Insp Reports Rec'd			Certificate of Occupancy Issued		
ADDITIONAL	INSPECTIONS, CORRECTIONS, ETC.					INSPECTIONS, CORRECTIONS, ETC.					
	PAID										
	JUN 5 1990										
	CITY OF INDIANAPOLIS										

PERMIT

CITY OF NAPOLEON - BUILDING DEPARTMENT

255 West Riverview Avenue, Napoleon, Ohio 43545 - 419-592-4010

Permit No. 01999 Issued _____ date _____

Job Location 265 Northcrest Drive address _____

Lot 26 Northcrest Add. sub-div or legal discript _____

Issued By Elden Huber building official _____

Owner Jr. Schroeder name _____ 589-0393 tel. _____

Address 265 Northcrest Drive _____

Agent Self builder-eng.-etc. _____ tel. _____

Address _____

Description of Use Residence _____

Residential 1 no. dwelling units _____

Commercial _____ Industrial _____

New Add'n. _____ Alter _____ Remodel _____

Mixed Occupancy _____

Change of Occupancy _____

Estimated Cost \$ 500.00 _____

FEE	BASE	PLUS	TOTAL
<input type="checkbox"/> BUILDING	9.00	.00	9.00
<input type="checkbox"/> ELECTRICAL			
<input type="checkbox"/> PLUMBING			
<input type="checkbox"/> MECHANICAL			
<input type="checkbox"/> DEMOLITION			
<input type="checkbox"/> ZONING			
<input type="checkbox"/> SIGN			
<input type="checkbox"/> WATER TAP			
SEW. INSP.			
SEWER TAP			
TEMP. WATER			
TEMP. ELECT.			
ADDITIONAL PLAN REVIEW	Struct. _____ hrs _____	Elect. _____ hrs _____	
TOTAL FEES.....			9.00
LESS MIN. FEES PAID _____ date _____			
BALANCE DUE.....			

ZONING INFORMATION

district	lot dimensions	area	front yd	side yds	rear yd
A	85' x 120'	10,200	85'	L-5' R-	10'
max hgt	no pkg spaces	no ldg spaces	max cover	petition or appeal req'd	date appr

WORK INFORMATION:

Size: Length 25' 01A Width _____ Stories _____ Ground Floor Area 471

Height _____ Building Volume (for demo. permit) _____ cu. ft.

Electrical: direct burial cable to existing outdoor circuit
brief description _____

Plumbing: _____
brief description _____

Mechanical: _____
brief description _____

Sign: _____ type _____ Dimensions _____ Sign Area _____

Additional Information: above ground pool Note: all metal parts & electrical equip. shall be grounded, provide a smoke detector in the house if there are none existing.

Date 6/7/90 Applicant Signature JR Schroeder owner-agent

PAID

JUN 07 1990

CITY OF NAPOLEON

APPLICATION
for
RESIDENTIAL BUILDING, ELECTRICAL, PLUMBING, MECHANICAL, PERMITS and DEMOLITION PERMIT
from the
CITY OF NAPOLEON - BUILDING DEPARTMENT

Entry No. _____ 255 West Riverview Ave. Napoleon, Ohio 43545 Pn. 419-592-4010

Permit No. <u>01999</u> Issued _____	Ck. Permits Reg.	Base	Fees Plus	Total
Job Location <u>265 Northcrest Drive</u>	<input checked="" type="checkbox"/> Building	<u>9.00</u>	<u>0</u>	<u>9.00</u>
Lot <u>26 NORTHCREST ADD</u> sub-div. or legal disc.	Electrical	_____	_____	_____
Issued By <u>51</u> building official	Plumbing	_____	_____	_____
Owner <u>JR Schroeder</u> Pn <u>599-0393</u>	Mechanical	_____	_____	_____
Address <u>265 Northcrest Drive</u>	Demolition	_____	_____	_____
Agent <u>SELF</u> Pn _____	Zoning	_____	_____	_____
Address <u>265 A</u>	Sign	_____	_____	_____
Description of Use <u>above ground swimming pool</u>	Water tap	_____	_____	_____
_____	Sewer Tap	_____	_____	_____
Residential <u>A</u> / no. dwelling units	Temp. Water	_____	_____	_____
Commercial _____ Industrial _____	Temp. Elec.	_____	_____	_____
New <input checked="" type="checkbox"/> Add'n. _____ Alter _____ Remodel _____	Additional struc. _____ hrs	_____	_____	_____
Mixed Occupancy _____	plan review _____	Elect. _____	_____	_____
Change of Occupancy _____	Total Fees.....	_____	<u>\$ 9.00</u>	_____
Estimated Cost \$ <u>500.00</u>	Less Min. Fees Pd. _____	_____	_____	_____
	date _____	_____	_____	_____
	Balance Due.....	_____	_____	_____

-ZONING INFORMATION

district	lot dimensions	area	front yd	side yds.	rear yd
<u>A</u>	<u>85' x 120'</u>	<u>10,200</u>	<u>85'</u>	<u>L-5' R-</u>	<u>10'</u>
max hgt	no pkg spaces	no ldg spaces	max cover	petition or appeal req'd.	date appr

WORK INFORMATION:

BUILDING: Garage Fl. Area _____ Basement Fl. Area _____ Second Floor Area _____

Size: Length 25' 0 1/2" Width _____ Stories _____ Ground Floor Area 471

Height _____ Building Volume (for demo. permit) _____ cu. ft.

Description of Work: REMOVE ABOVE GROUND POOL. NOTE: ALL REMOVAL PARTS
+ ELECTRICAL EQUIP. SHALL BE GROUNDED PROVIDED
SMOKE DETECTOR IN THIS HOUSE IF THEIR ARE NONE EXISTING.

JUN 07 1990
CITY OF NAPOLEON

ELECTRICAL: Electrical Contractor _____ Pn. _____

Address _____ Estimated Cost \$ _____

Type of work: New _____ Service change _____ Rewiring _____ Additional Wiring X to an existing circuit Temp. Elec. Req. _____ yes no

Size of service _____ Underground _____ Overhead _____ No. of new circuits _____

Description of work: DIRECT BURIAL CABLE TO EXISTING outdoor circuit

PLUMBING: Plumbing Contractor _____ Pn. _____

Address _____ Estimated Cost \$ _____

Water Tap Req. _____ Size _____ Type of Pipe _____ Water Dist. Pipe _____ type

San. Sewer Tap Req. _____ Size _____ Type of Pipe _____ Dr. Waste Vt. Pipe _____ type

St. Sewer Tap Req. _____ Size _____ Type of Pipe _____ Street to be Opened _____ yes no

Main Building Drain Size _____ Main Vent Pipe Size _____ List Number of Plumbing Fixtures Below

Water Closets _____ Bathtubs _____ Showers _____ Lavatories _____ Kitchen Sinks _____ Disposal _____ Dishwasher _____ Clothes Washer _____

Floor Drains _____ Other Fixtures: Type _____ No. _____

Description of Work: _____

MECHANICAL: Mechanical Contractor _____ Pn. _____

Address _____ Estimated Cost _____

Heating System: Forced Air _____ Gravity _____ Hot Water _____ Steam _____ Unit Heaters _____ Radiant _____ Baseboard _____

Type of Fuel: Electric _____ Natural Gas _____ Propane _____ Wood _____ Coal _____ Solar _____ Geothermal _____ Other _____

No. of Heat Zones _____ Hot Water: (One Pipe _____ Two Pipe _____ Series Loop _____) Electric Heat: (No of Circuits _____) No. of Furnaces _____

No. of Hot Air Runs _____ No. of Hot Water Radiators _____ Total Heat Loss _____ Rated Capacity of Furnace/Boiler _____

Location of Heating Units: Crawl Space _____ Floor Level _____ Attic _____ Suspended _____ Roof _____ Outside _____ Other _____

Description of Work above ground swimming pool

4598 120x85

DRAWINGS REQUIRED: All Applications must be Accompanied by Two Complete sets of Drawings Including SITE PLAN, FOUNDATION PLAN, FLOOR PLANS, STRUCTURAL FRAMING PLANS, EXTERIOR ELEVATIONS, SECTIONS and DETAILS, STAIR DETAILS, ELECTRICAL LAYOUT, PLUMBING ISOMETRIC, HEATING LAYOUT ETC. All plans shall be DRAWN TO SCALE. Show all existing structures on the site plan also, show Electric Panel and Furnace Locations.

READ AND SIGN BELOW; The undersigned hereby makes application for a permit for all work described herein, and agrees to complete the work in strict accordance with all applicable provisions of the current edition of the C.A.B.D. Building Code, the Napoleon Building and Zoning Codes, the Napoleon Engineering Dept. Rules and Regulations, Standard Specifications and other Pertinent Sections of the Napoleon Code of Ordinances.

Date 6/7/90 Signature of Applicant JR Schroeder **PAID**

Application not valid without signature **JUN 07 1990**

CITY OF NAPOLEON

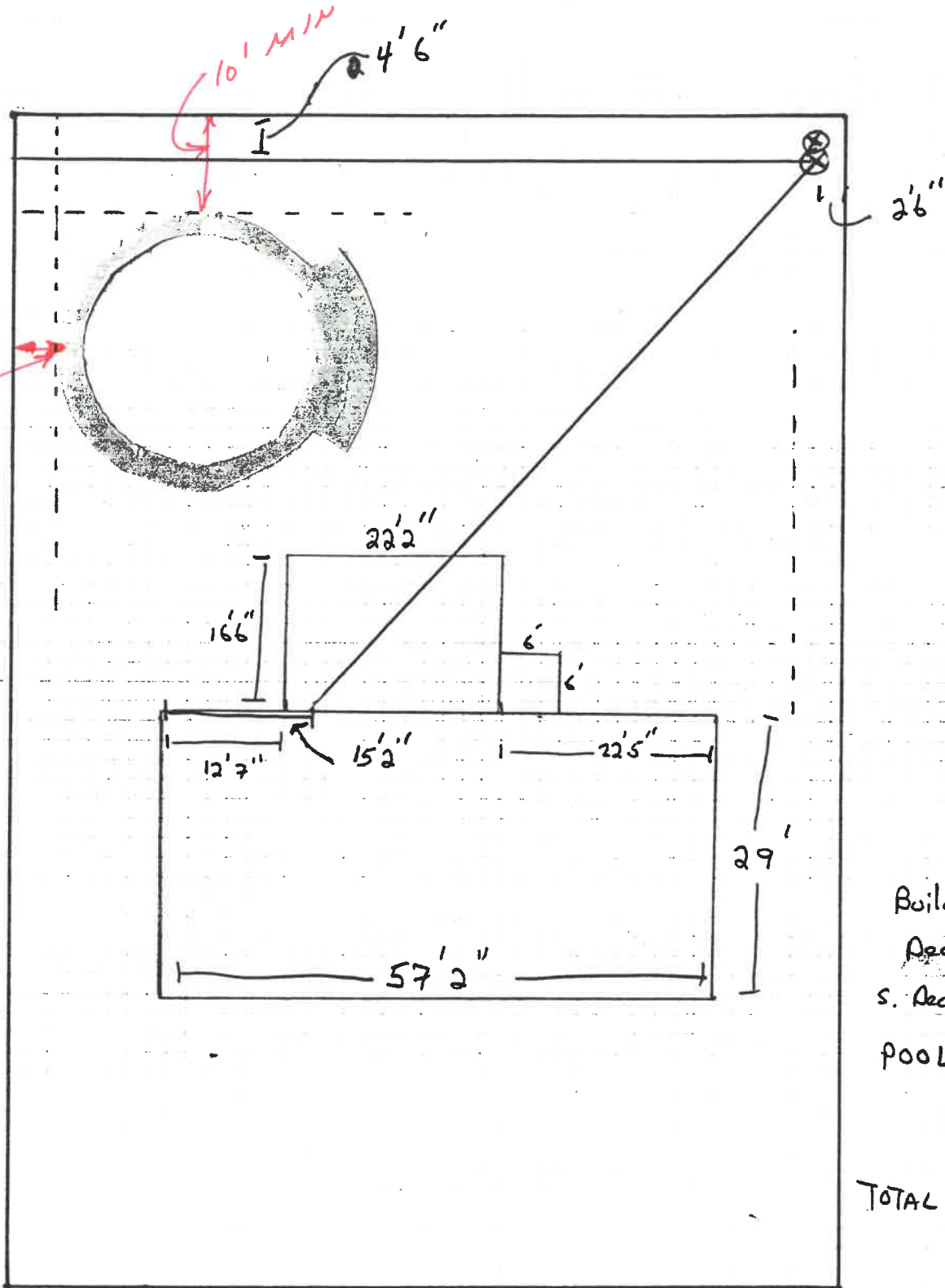

120'

Building = 1658 sq ft
 Deck = 366 sq ft
 S. Deck = 36 sq ft
 Pool = 716 sq ft
2776 sq ft

TOTAL = 10,200 sq ft

85'

1 sq = 2 ft.

27.2%

