

THE CITY OF NAPOLEON

BUILDING & ZONING DEPARTMENT

255 W. RIVERVIEW

(419)592-4010

Building Permit

Page 1 of 1

Permit Number: BP2005-71

Printed: 5/17/2005

Property Address: 275 Northcrest Dr

Applicant Morlocks Remodeling & General Carpentry
Address: 17-626 Co Rd J

Approval Date: 5/17/2005

Napoleon, OH 43545

Phone: 419-762-5355

Owners

Name: Mr. Nancy Witte
Address: 275 Northcrest Dr

Phone: 419-592-6134

Contractors Morlocks Remodeling & General Carpentry
Address: 17-626 Co Rd J
Napoleon, OH 43545

Phone 419-762-5355

Fees and Receipts:

Number	Description	Amount
FEE2005-428	Building Permit Fee (Auto)	\$20.00
Total Fees:		\$20.00

Description

Structure Use:

Start Date:

Construction Value: \$6,000.00

End Date:

Floor Areas

Living Space:

Other:

Basement/Storage:

Total Area:

Garage:

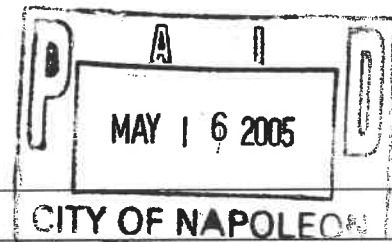

Description of work to be done: Fence

Applicant signature:

A handwritten signature in black ink, appearing to read "Paul C. Moore". The signature is written in a cursive style and is positioned over a horizontal line.

Date:

5-17-05

86' 0"

6' Vinyl Fence

6' privacy Fence is being replaced ~~with~~ inside assumed property lines

64' 0"

60' 6"

275 Northcrest

12' 6"

82' 3"

55' 3"

~~27~~ Northcrest Drive

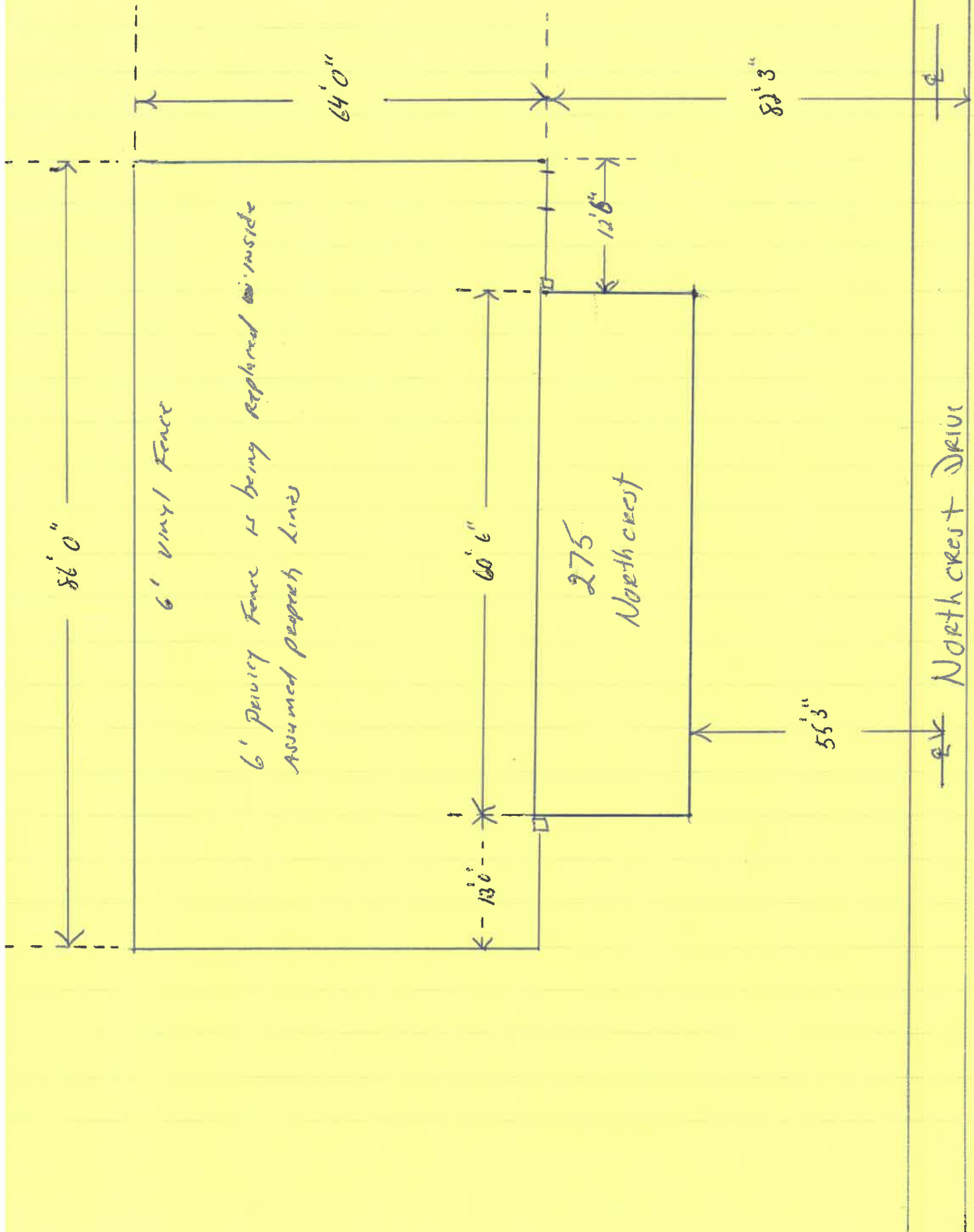

CITY OF NAPOLEON GENERAL PERMIT APPLICATION

THIS APPLICATION IS FOR RESIDENTAL CONSTRUCTION INCLUDING BUILDING, ELECTRICAL, PLUMBING, MECHANICAL, DEMOLITIONS, REMODELING.

DATE: 5-17-05 JOB LOCATION: 275 Northcrest Dr

OWNER: Nancy Witte PHONE: 419-592-6134

OWNER ADDRESS: 275 Northcrest Dr CITY: Napoleon ZIP: 43545

CONTRACTOR: Merlock Remodeling PHONE: 419-762-5355

CONTRACTOR LICENSED WITH THE CITY OF NAPOLEON?: YES: _____ NO: _____

Is any of this job going to be subcontracted out? Yes: _____ No:

If yes to whom: _____

DESCRIPTION OF WORK TO BE PERFORMED: _____

PLEASE MARK THE TYPE OF WORK YOU WILL BE PERFORMING

- | | |
|---|--|
| <input type="checkbox"/> A/C ADD ON | <input type="checkbox"/> REMODELING |
| <input type="checkbox"/> BOILER REPLACEMENT | <input type="checkbox"/> ROOFING |
| <input type="checkbox"/> CURBING | <input type="checkbox"/> SEWER REPAIRS** |
| <input type="checkbox"/> DECKS * | <input type="checkbox"/> SIDEWALK* |
| <input type="checkbox"/> DRIVEWAY* | <input type="checkbox"/> SIDING |
| <input type="checkbox"/> ELECTRICAL SERVICE UPGRADE | <input type="checkbox"/> STORAGE SHED* |
| <input type="checkbox"/> ELECTRICAL SERVICE NEW | <input type="checkbox"/> SWIMMING POOL* |
| <input checked="" type="checkbox"/> FENCE* | <input type="checkbox"/> FURNACE REPLACEMENT |
| <input type="checkbox"/> ADDITIONS* | <input type="checkbox"/> TEMP ELECTRIC |
| <input type="checkbox"/> FURNACE NEW | <input type="checkbox"/> WATER TAP (size _____") |
| <input type="checkbox"/> LAWN METER | <input type="checkbox"/> WINDOWS |
| <input type="checkbox"/> PLUMBING | <input type="checkbox"/> ZONING |

*PLEASE INCLUDE A PICTURE SHOWING MEASUREMENTS FROM EXISTING STRUCTURES AND PROPERTY LINES. INDICATING THE TYPE OF WORK YOU WISH TO PERFORM.

** IF WORK REQUIRES GOING INTO THE STREET A STREET BOND IS REQUIRED!

FOR PERMIT COSTS PLEASE FILL OUT REVERSE SIDE.

PERMIT COST WORKSHEET

JOB	BASE FEE	TOTAL
SIDING (only) TOTAL SQ _____ X 1.00 +	\$5.00 =	\$ _____
ROOFING (only) TOTAL SQ _____ X 1.00 +	\$5.00 =	\$ _____
WINDOWS (only) # OF WINDOWS ___ X 1.00 +	\$5.00 =	\$ _____
ELECTRICAL # OF CIRCUITS _____ X 3.00 +	\$15.00 =	\$ _____
ELECTRICAL SERVICE UPGRADE	\$15.00 =	\$ _____
PLUMBING (INSIDE) repairs only	\$10.00 =	\$ _____
PLUMBING/SEWER (OUTSIDE)	\$25.00 =	\$ _____
WATER HEATER	\$5.00	\$ _____
SHED UNDER 200 SQ FT	\$ 5.00	\$ _____
FURNACE OR A/C (REPLACEMNT)	\$ 5.00	\$ _____
DEMOLITION (only)	\$30.00	\$ _____
SIDEWALK REPLACEMENT/ NEW	\$25.00	\$ _____
DRIVEWAY	\$25.00	\$ _____

ALL CONSTRUCTION, ALTERATIONS, REMODELING, SHEDS, DECKS & FENCES NOT LISTED ABOVE IS BASED ON COST OF WORK BEING PERFORMED.

COST OF WORK \$ 6,000.00 (SEE CHART) \$ 20.00

0.00	-	250.00	0.00	11,000.00	-	11,999.00	25.00
250.00	-	1,000.00	10.00	12,000.00	-	12,999.00	26.00
1,000.00	-	1,999.00	12.00	13,000.00	-	13,999.00	27.00
2,000.00	-	2,999.00	14.00	14,000.00	-	14,999.00	28.00
3,000.00	-	3,999.00	16.00	15,000.00	-	15,999.00	29.00
4,000.00	-	4,999.00	18.00	16,000.00	-	16,999.00	30.00
5,000.00	-	5,999.00	19.00	17,000.00	-	17,999.00	31.00
6,000.00	-	6,999.00	<u>20.00</u>	18,000.00	-	18,999.00	32.00
7,000.00	-	7,999.00	21.00	19,000.00	-	19,999.00	33.00
8,000.00	-	8,999.00	22.00	20,000.00	-	20,999.00	34.00
9,000.00	-	9,999.00	23.00	21,000.00	-	21,999.00	35.00
10,000.00	-	10,999.00	24.00	22,000.00	-	22,999.00	36.00
				Over 22,999		Please Call	