

599-7665

CITY OF NAPOLEON  
BUILDING INSPECTION DEPARTMENT  
APPLICATION FOR BUILDING PERMIT  
(Please print or type)

The undersigned hereby makes application for construction, installation, or alteration work as herein specified, agreeing to do all such work in strict accordance with the City of Napoleon's adopted Building Codes.

Location of project 275 Northcrest Dr Cost of project \$13,390.<sup>00</sup>

Owner's Name Daniel Witte Address 275 Northcrest Dr.

Contractor Oberhaus Pools Telephone No. 274-2362

Address H-534 Rd 7 Rt. 2 Deshler

Lot Information: (Not required for siding job)

Lot No. \_\_\_\_\_ Subdivision \_\_\_\_\_

Zoning District \_\_\_\_\_ Lot Size \_\_\_\_\_ ft. X \_\_\_\_\_ ft. Area \_\_\_\_\_ sq. ft.

Setbacks: Front \_\_\_\_\_ Right Side \_\_\_\_\_ Left Side \_\_\_\_\_ Rear \_\_\_\_\_

Work Information:

Residential  Commercial \_\_\_\_\_ Industrial \_\_\_\_\_

New Construction \_\_\_\_\_ Addition \_\_\_\_\_ Remodel \_\_\_\_\_

Accessory Building \_\_\_\_\_ Siding \_\_\_\_\_

(Specific Type)

Brief Description of Work:----- Inground Pool

Size: Length \_\_\_\_\_ Width \_\_\_\_\_ No. of Stories \_\_\_\_\_

Area: 1st Floor \_\_\_\_\_ sq. ft. Basement \_\_\_\_\_ sq. ft.

2nd Floor \_\_\_\_\_ sq. ft. Accessory Bldg. \_\_\_\_\_ sq. ft.

3rd Floor \_\_\_\_\_ sq. ft. Other \_\_\_\_\_ sq. ft.

Additional Information: \_\_\_\_\_

APPLICATION FOR PERMIT SHALL BE ACCOMPANIED BY TWO COMPLETE SETS OF PLANS INCLUDING: ELEVATIONS, FLOOR PLANS, CROSS SECTIONS AND PLOT PLAN. IF ADDITION OR REMODELING, SHOW ALL EXISTING STRUCTURES AND THEIR SIZE AND LOCATION. ALL PLANS SHALL BE DRAWN TO SCALE.

Date 6/26/86 Applicant's Signature James C. Oberhaus

PERMIT NO. \_\_\_\_\_  
PERMIT FEE \$ \_\_\_\_\_



CITY OF NAPOLEON  
BUILDING INSPECTION DEPARTMENT  
APPLICATION FOR ELECTRICAL PERMIT  
(Please print or type)

The undersigned hereby makes application for installation or replacement of electrical equipment as herein specified, agreeing to do all such work in strict accordance with the City of Napoleon's adopted Electrical Codes.

Owner's Name Daniel Witte Address 275 Northcrest Dr.

Electrical Contractor Oberhaus Pools Telephone No. 274-2362

Address H-534 Rd 7 Rt. 2 Deshler

General Contractor same Telephone No. \_\_\_\_\_

Address \_\_\_\_\_

Location of Project 275 Northcrest Dr. Cost of Project \$13,390

Work Information:

Residential  Commercial \_\_\_\_\_ Industrial \_\_\_\_\_

No. Units \_\_\_\_\_

New \_\_\_\_\_ Service Change \_\_\_\_\_ Rewiring \_\_\_\_\_ Additional Wiring \_\_\_\_\_

Brief Description of Work: 1 sub panel with a 220V. GFI  
for pump ~~and a 120V GFI for light~~

Size of proposed service entrance \_\_\_\_\_ Number of new circuits 1

Type of proposed service entrance \_\_\_\_\_ Underground \_\_\_\_\_ Overhead \_\_\_\_\_

Require Temporary Electric \_\_\_\_\_ (Yes or No) No

Total Floor Area - Commercial and Industrial only \_\_\_\_\_ sq. ft.

Additional Information: \_\_\_\_\_

\*Ground fault circuit interrupter protection is required on all 120-volt single phase, 15 and 20 amp. Circuits which are part of a temporary electric service: and also on bathroom, outdoor, and garage receptacles in all dwelling units. Art. 220-8 N.E.C.

\*Application for permit shall be accompanied by two complete sets of plans including: Electrical layout and riser diagram. (For commercial and industrial work only).

Date 6/28/86 Applicant's Signature James C Oberhaus

PERMIT NO. \_\_\_\_\_  
PERMIT FEE \$ \_\_\_\_\_



275 NORTHCREST DRIVE

LOT # 25 NORTHCREST ADDITION

B-DISTRICT

F  
25'

R  
15'

S  
5'

45%  
COVERAGE

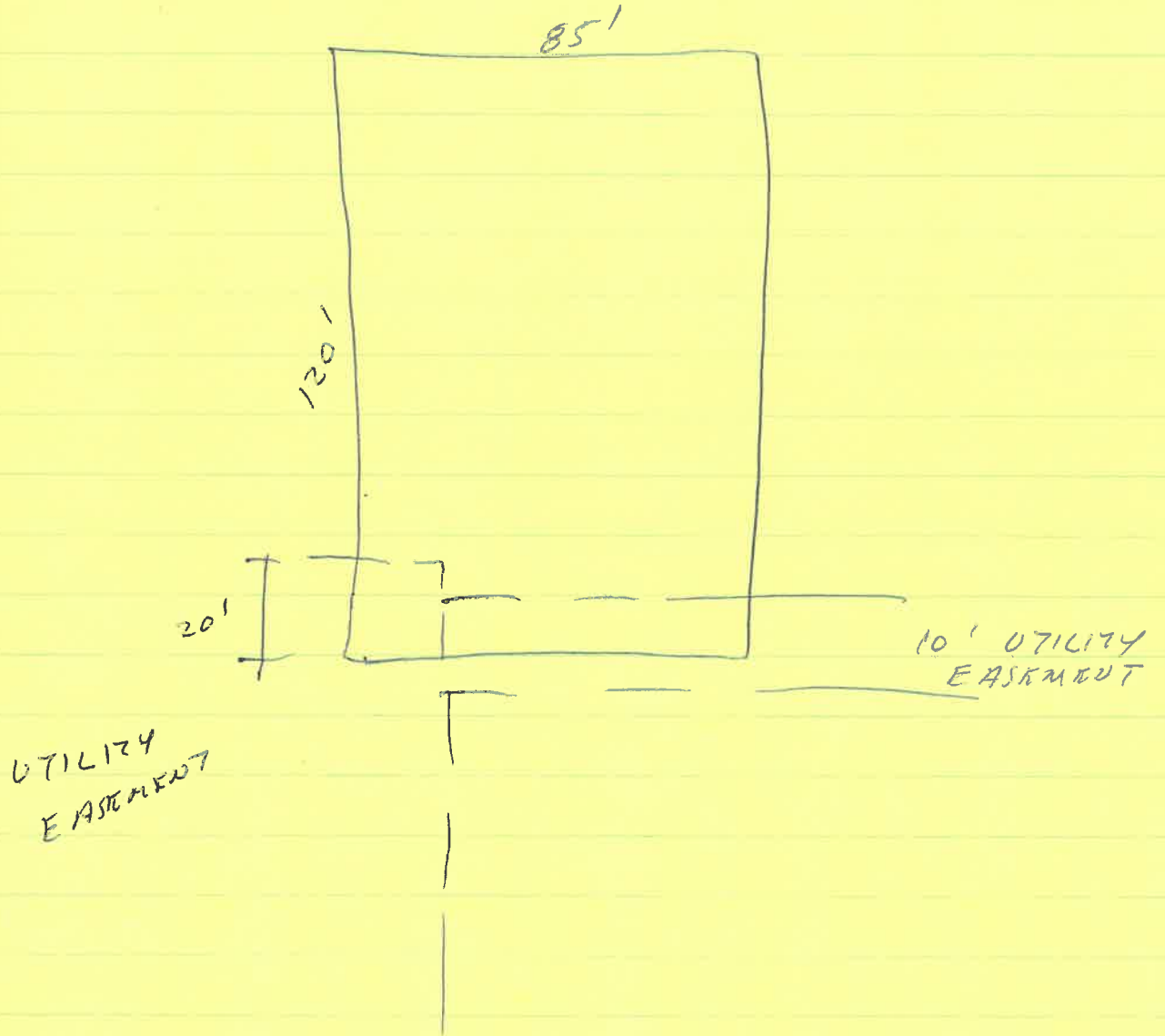



1021

Daniel Witte  
275 Northcrest Dr  
Napoleon

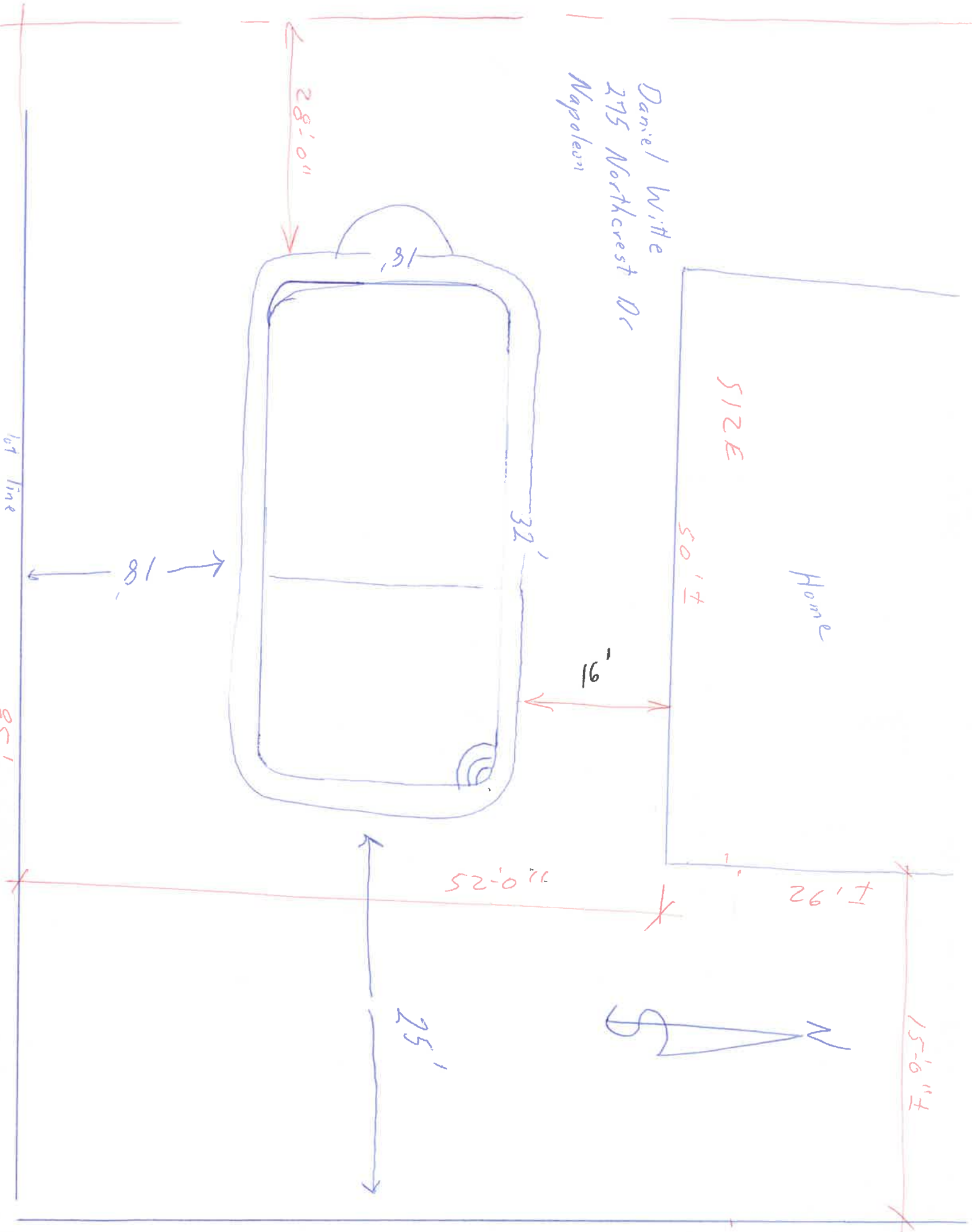

lot line

85'

28'±

18'

32'

16'

SIZE

50'±

Home

± 26'

52'±

25'

15'±







✓ LOCATION OF POOL FROM  
HOUSE

✓ LOCATION OF HOUSE FROM LOT LINES

✓ SIZE OF HOUSE

$$50 \times 26 = 1300 \text{ SQ. FT.}$$

$$38 \times 24 = \frac{912}{2212 \text{ SQ. FT.}}$$

COORRAGN OK

