

APPLICATION FOR PERMIT TO TAP SEWER

Owner Ron Patton
ADDRESS 1466 Oakwood Ave.
CONTRACTOR Jerry Glanz
ADDRESS Lakeview TEL. 599-4103

NO. SA 0049-88
BLDG. PERMIT NONE
^{Inspection}
~~PERMIT~~ FEE \$ 60.00
STREET BOND —
DATE PAID 4-25-88
For office use only

LOCATION OF CONNECTION

Street and No. Oakwood Ave Sanitary Storm
Lot No. 15 Subdivision Fairground Add. Size of Tap 4" P.V.C.
Size and Type of Sewer 4" P.V.C. ALL WORK MUST BE INSPECTED
Street to be opened-Yes No Opening bond fee set by Engineer \$ None
Street opening agreement approval date None

I certify that the sewer will be used only as indicated and no other drainage will be connected.

Date 4-25-88 Signature Ronald L. Patton
Owner-Builder-Agent

DO NOT WRITE BELOW THIS LINE

INSPECTION RECORD

Date Inspected 4-28-88 Size and Type of Sewer 4" P.V.C.
Location — Depth — Type of Test —
Inspected and Approved by: Malcolm Nelbery 4-28-88
Inspector Date

Additional information —

Send copy to: —

SKETCH OF INSTALLATION - ON BACK

see attached

PAID
APR 25 1988
CITY OF NAPOLEON

PAY-IN ORDER

CITY OF NAPOLEON

Nº 8988

4-25, 1988

Received of Ron Patton

PAY TO THE TREASURER OF SAID CITY

Sixty and 00/100 DOLLARS, \$ 60.

For Sanitary Sewer¹⁰⁰ Inspection Fee

which amount is to be placed to the credit of _____ Fund

G.W. Schivenhagen

CLERK-TREASURER

CITY OF NAPOLEON
ENGINEERING DEPT.
255 W. RIVERVIEW
NAPOLEON, OH 43545
1466 OAKWOOD AVE

JOB SEWER TAP - SA 0049-88
SHEET NO _____ OF _____
CALCULATED BY STJ DATE 5/5/88
CHECKED BY _____ DATE _____
SCALE 1" = 20'

FAIR ST. - 60' R/W

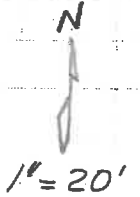

OAKWOOD AVE.

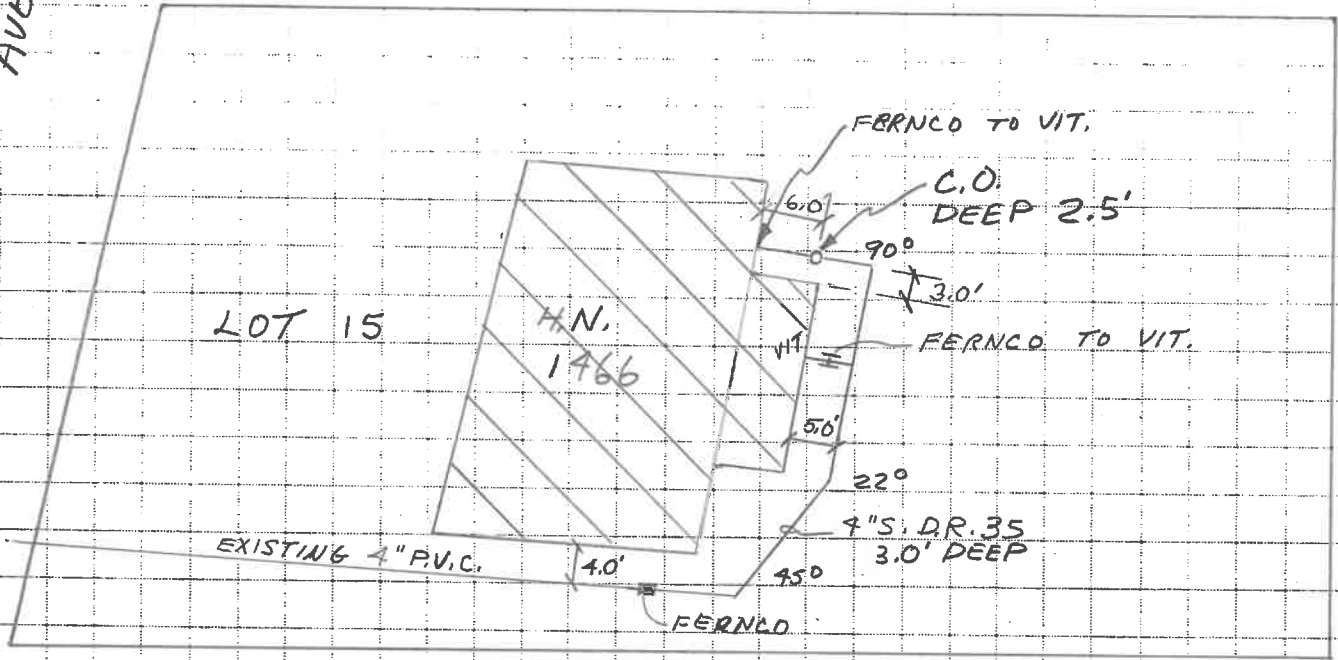

LOT 15 FAIRGROUND ADD
LOT 122' X 68.3'

14166 ?

Oakwood Ave

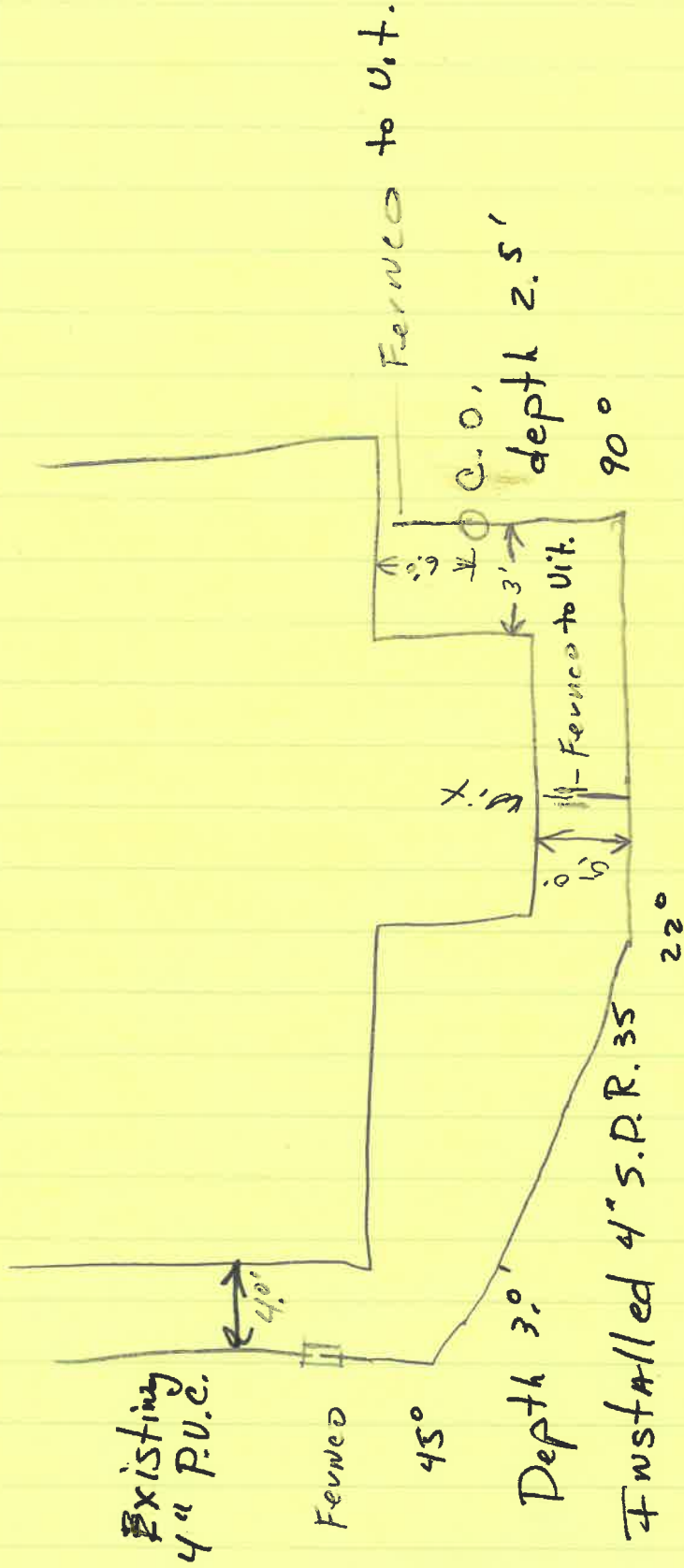

REAR of house

MATCH LINE

30 to sec 11

47-1
671.01

670

RP

FAIR STREET

670

680
676.4
680.6
C.B.

C.L. 1966

680.9

PARKING
681.4

HUDSON STREET

681.1

680.9
C.B.

X- 681.8
C.B. 680 out

1/4 SEC LINE

ST. M.H.

681.2

680.9
C.B.

SAN
O.M.H.

ST. M.H.

691.1

681.3

680.8

680.4

ST. M.H.

X 680.9

C.L.

C.L.

691.9

680

1" = 100'