

THE CITY OF NAPOLEON

BUILDING & ZONING DEPARTMENT

255 W. RIVERVIEW

(419)592-4010

Building Permit

Page 1 of 1

Permit Number: BP2005-83

Printed: 5/27/2005

Property Address:

1440 Sedward Ave.

Applicant Eric Hanson
Address: 1440 Sedward Ave

Approval Date: 5/27/2005

Napoleon, OH 43545

Phone: 419-592-1529

Owners

Name: Mr. Eric Hanson
Address: 1440 Sedward Ave

Phone: 419-592-1529

Contractors

Fees and Receipts:

Number	Description	Amount
FEE2005-452	Building Permit Fee (Auto)	\$10.00
Total Fees:		\$10.00

Description

Structure Use:

Construction Value: \$800.00

Floor Areas

Living Space:

Basement/Storage:

Garage:

Start Date:

End Date:

Other:

Total Area:

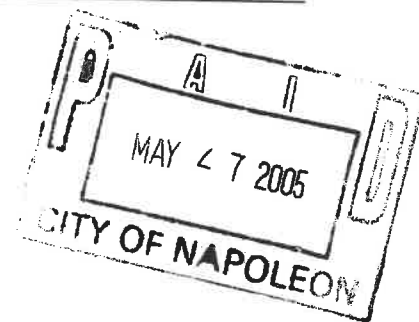

Description of work to be done: deck

Applicant signature: _____ **Date:** _____

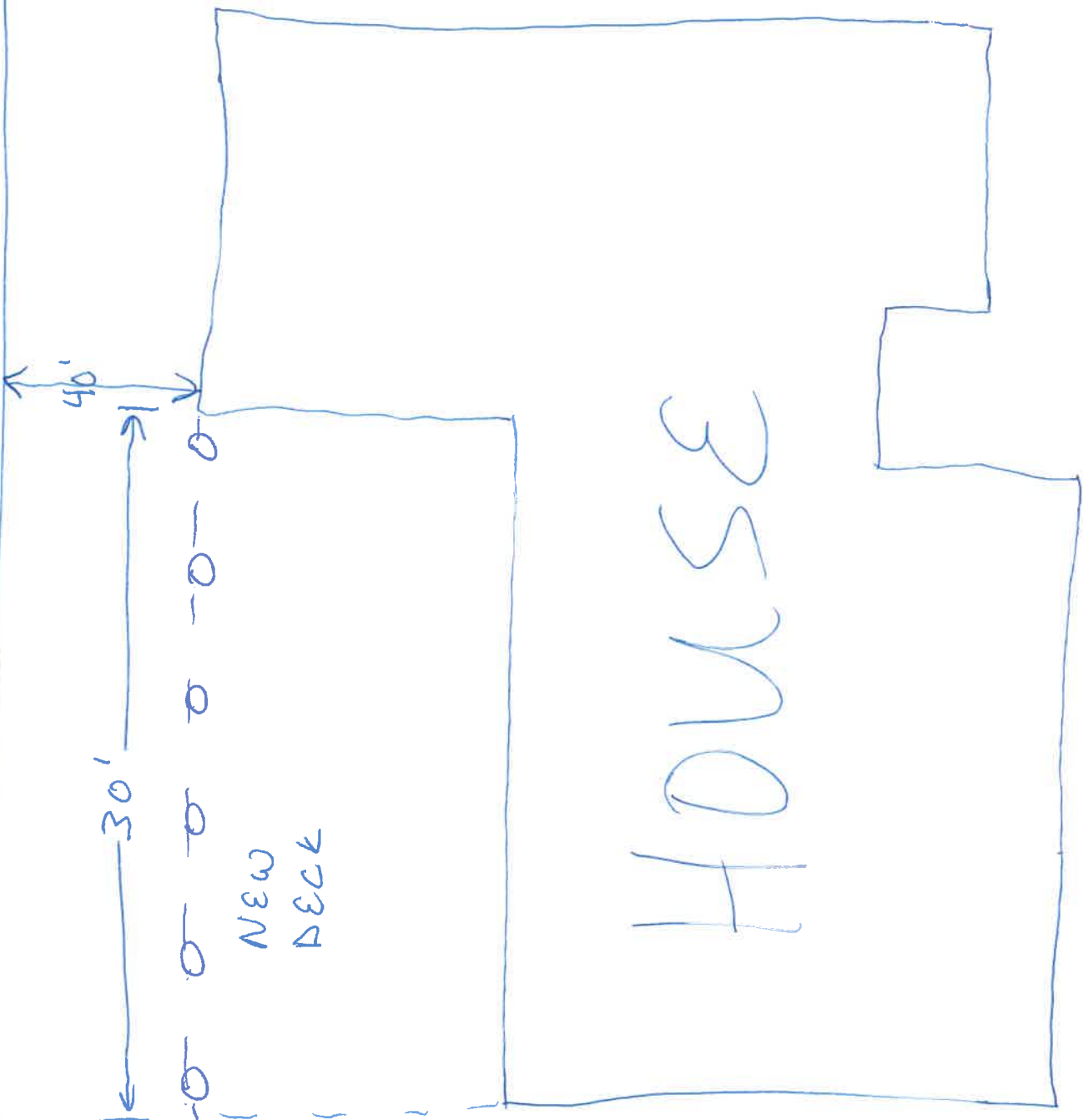
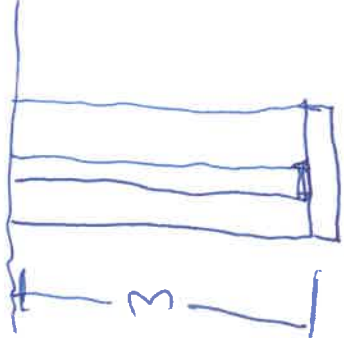

HOUSE

NEW
DECK

40'

30'

14'

16'

3

CITY OF NAPOLEON GENERAL PERMIT APPLICATION

THIS APPLICATION IS FOR RESIDENTIAL CONSTRUCTION INCLUDING BUILDING, ELECTRICAL, PLUMBING, MECHANICAL, DEMOLITIONS, REMODELING.

DATE: 5/27 JOB LOCATION: 1440 Sedward

OWNER: Eric M Hanson PHONE: (419) 592-1559

OWNER ADDRESS: 1440 Sedward CITY: Napoleon ZIP: 43545

CONTRACTOR: NONE PHONE: _____

CONTRACTOR LICENSED WITH THE CITY OF NAPOLEON?: YES: _____ NO: X

Is any of this job going to be subcontracted out? Yes: _____ No: X

If yes to whom: _____

DESCRIPTION OF WORK TO BE PERFORMED: _____

PLEASE MARK THE TYPE OF WORK YOU WILL BE PERFORMING

- | | |
|---|--|
| <input type="checkbox"/> A/C ADD ON | <input type="checkbox"/> REMODELING |
| <input type="checkbox"/> BOILER REPLACEMENT | <input type="checkbox"/> ROOFING |
| <input type="checkbox"/> CURBING | <input type="checkbox"/> SEWER REPAIRS** |
| <input checked="" type="checkbox"/> DECKS * | <input type="checkbox"/> SIDEWALK* |
| <input type="checkbox"/> DRIVEWAY* | <input type="checkbox"/> SIDING |
| <input type="checkbox"/> ELECTRICAL SERVICE UPGRADE | <input type="checkbox"/> STORAGE SHED* |
| <input type="checkbox"/> ELECTRICAL SERVICE NEW | <input type="checkbox"/> SWIMMING POOL* |
| <input type="checkbox"/> FENCE* | <input type="checkbox"/> FURNACE REPLACEMENT |
| <input type="checkbox"/> ADDITIONS* | <input type="checkbox"/> TEMP ELECTRIC |
| <input type="checkbox"/> FURNACE NEW | <input type="checkbox"/> WATER TAP (size _____") |
| <input type="checkbox"/> LAWN METER | <input type="checkbox"/> WINDOWS |
| <input type="checkbox"/> PLUMBING | <input type="checkbox"/> ZONING |

*PLEASE INCLUDE A PICTURE SHOWING MEASUREMENTS FROM EXISTING STRUCTURES AND PROPERTY LINES. INDICATING THE TYPE OF WORK YOU WISH TO PERFORM.

** IF WORK REQUIRES GOING INTO THE STREET A STREET BOND IS REQUIRED!

FOR PERMIT COSTS PLEASE FILL OUT REVERSE SIDE.