

# CITY OF NAPOLEON ZONING PERMIT APPLICATION

THIS APPLICATION IS FOR RESIDENTIAL DEMOLITIONS, FENCES, POOLS, SHEDS,  
DRIVEWAYS, SIDEWALKS & SEWERS

KH 13-101  
Outside Sewer

DATE 2-28-13 JOB LOCATION 814 Third

OWNER \_\_\_\_\_ TELEPHONE # \_\_\_\_\_

OWNER ADDRESS \_\_\_\_\_

CONTRACTOR Tressler Plumbing CELL PHONE # \_\_\_\_\_

DESCRIPTION OF WORK TO BE PERFORMED New sewer lateral

ESTIMATED COMPLETION DATE 3-1-13 ESTIMATED COST 3000

DESCRIPTION	FEE	TOTAL COST
Demo Permit	(100.3100.46690) \$100.00	\$
Fence	(100.3100.46690) \$25.00	\$
Pool	(100.3100.46690) \$25.00	\$
Garage and Shed Under 200 SF (Detached)	(100.3100.46690) \$25.00	\$
Driveway	0	\$
Sidewalk/Curbing	0	\$
Sewer Outside	0	\$ <u>0</u>
<b>Subtotal:</b>		\$
		\$
<b>TOTAL FEE:</b>		\$

**I FULLY UNDERSTAND THAT NO EXCAVATION, CONSTRUCTION OR STRUCTURAL ALTERATION, ELECTRICAL OR MECHANICAL INSTALLATION OR ALTERATION OF ANY BUILDING STRUCTURE, SIGN, OR PART THEREOF AND NO USE OF THE ABOVE SHALL BE UNDERTAKEN OR PERFORMED UNTIL THE PERMIT APPLIED FOR HEREIN HAS BEEN APPROVED AND ISSUED BY THE CITY OF NAPOLEON BUILDING/ZONING DEPARTMENT.**

*I hereby certify that I am the Owner of the named property, or that the proposed work is authorized by the Owner of record and that I have been authorized by the Owner to make this application as his/her authorized agent and I agree to conform to all applicable laws of the jurisdiction. In addition, if a permit for Work described in this application is issued, I certify that the code official or the code official's authorized representative shall have the authority to enter areas covered by such permit at any reasonable hour to enforce the provisions of the code(s) applicable to such permit.*

**I HEREBY ACKNOWLEDGE THAT I HAVE READ AND FULLY UNDERSTAND THE ABOVE LISTED INSTRUCTIONS.**

SIGNATURE OF APPLICANT: [Signature] DATE: 2-28-13

PRINT NAME: \_\_\_\_\_

PERMIT #	BATCH #	CHECK #	DATE
----------	---------	---------	------

DATE: 3-1-13

INSTALLED BY: TRESSLER PLUMBING

INSPECTED BY: MARTY CROSSLAND



10" San

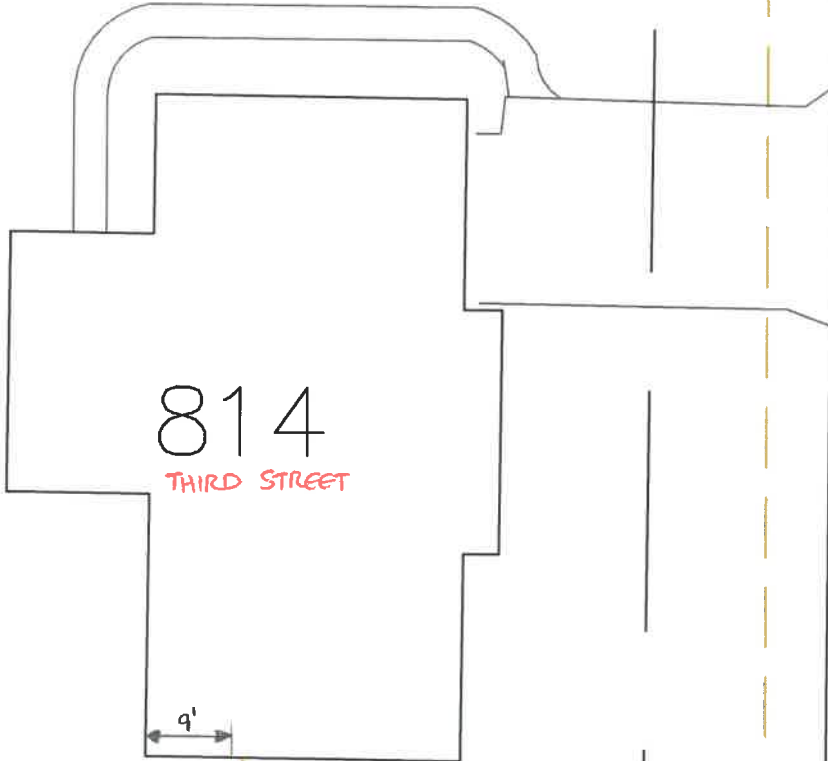

THIRD STREET

